

# CORNER RECORD

Document Number 3034

City of \_\_\_\_\_ County of MERCED, California

Brief Legal Description N.E. COR. SECT 21, T10S R12E N10B&M

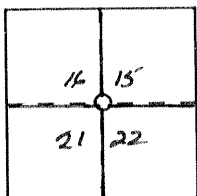

### CORNER TYPE

Government Corner  Control   
 Meander  Property   
 Rancho  Other   
 Date of Survey 6-27-90

### COORDINATES (Optional)

N. \_\_\_\_\_  
 E. \_\_\_\_\_  
 Zone \_\_\_\_\_ Datum \_\_\_\_\_  
 Elev. \_\_\_\_\_

Corner — Left as found  Found and tagged  Established  Reestablished  Rebuilt

Identification and type of corner found: Evidence used to identify or procedure used to establish or reestablish the corner: FOUND BRASS CAP IN MON. WELL - DOWN 0<sup>3</sup> FROM SURFACE

A description of the physical condition of the monument as found and as set or reset: MONUMENT IN GOOD CONDITION - SET 2' RPS N&E&NW

### SURVEYOR'S STATEMENT

This Corner Record was prepared by me or under my direction in conformance with the Land Surveyors' Act on JUNE 27 1990.

Signed Ralph N. Scheel, Jr. L.S. or R.C.E. Number LS3730

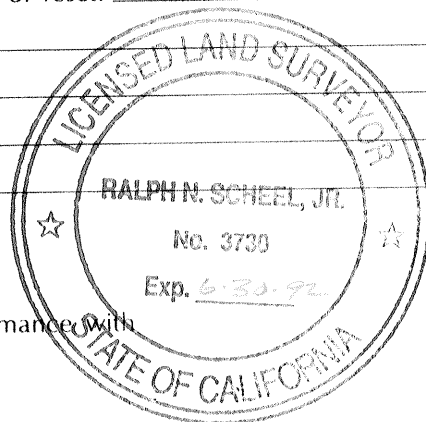

### COUNTY SURVEYOR'S STATEMENT

This Corner Record was received August 1990 and examined and filed August 22 1990.

Signed Roy L. Turney Title Dep. Co. Surveyor

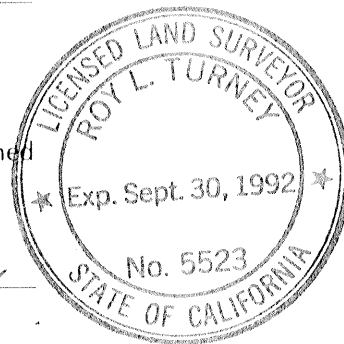

County Surveyor's Comment COR. # 3034  
Corner agrees with Corner Record

16	15	T 105 R 12 E
21	22	M D B & M

9 10  
16 15  
FD. 3/4" I. PIPE  
L.S. ...  
FLUSH  
NO RECORD

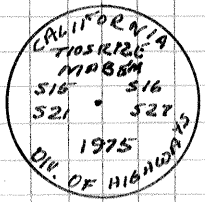
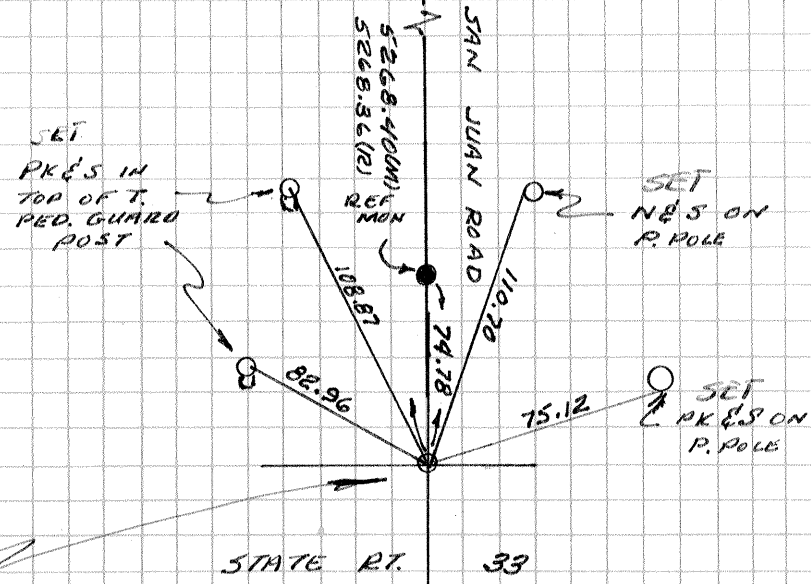

FOUND  
3 1/2" BRASS CAP down 0'  
IN MON. WELL - 0.3' below  
surface of PAVEMENT