

COUNTY OF Merced T. 10 S. R. 9 E. M.D.B. & MERIDIAN CALIFORNIA

CORNER TYPE: GOV'T. CORNER [x] MEANDER [] RANCHO [] CONTROL [] OTHER []

CORNER IDENTIFICATION — DATE OF VISIT January 17, 19 77

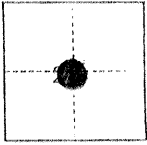

Center quarter corner of Section 28

CORNER — LEFT AS FOUND [] FOUND AND TAGGED [] REESTABLISHED OBLITERATED CORNER [] REBUILT [x]

PHYSICAL DESCRIPTION OF CORNER FOUND; EVIDENCE AND METHOD USED TO IDENTIFY OR REESTABLISH

Set 1" x 28" O.D. pipe with plug marked L.S. 4156 1 ft. below ground line FROM SWING TIES

PHYSICAL DESCRIPTION OF MONUMENTS REBUILT OR PERPETUATED

CALIFORNIA COORDINATE SYSTEM ORDER: FIRST [] SECOND [] THIRD [] STATIONS USED: NGS (USC & GS) [] STATE [] COUNTY [] OTHER [] STATION _____ ELEVATION _____ NORTHINGS (Y) _____ EASTINGS (X) _____

SKETCH: (Include reference tie or witness points, remarks and topo of area)

- 16.62 ft. Southwest of chisled X in 42" concrete stand pipe
26.68 ft. Southeast of chisled X in 42" concrete stand pipe
20.40 ft. North of top 3" steel fence post
10.10 ft. Northeast of top 3" steel fence post

SURVEYOR'S CERTIFICATE

THIS CORNER RECORD WAS PREPARED BY ME OR UNDER MY DIRECTION IN CONFORMANCE WITH THE LAND SURVEYORS ACT ON Jan. 29 1977

SIGNED: [Signature]

L.S. or R.C.E. No.:

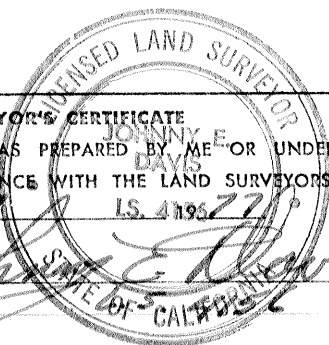

COUNTY SURVEYOR'S CERTIFICATE

THE CORNER RECORD WAS RECEIVED _____ 19 _____ AND EXAMINED AND FILED _____ 19 _____

BY: _____

TITLE: _____

DOCUMENT No. 3022A