

COUNTY OF Merced T. 11 S R. 11 E M.D.B. & MERIDIAN CALIFORNIA

CORNER TYPE: GOVT. CORNER [X] MEANDER [] RANCHO [] CONTROL [] OTHER []
CORNER IDENTIFICATION — DATE OF VISIT October 15, 19 85

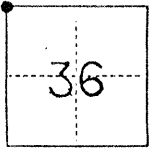

Northwest corner of Section 36, 11/11

CORNER — LEFT AS FOUND [] FOUND AND TAGGED [X] REESTABLISHED OBLITERATED CORNER [] REBUILT []

PHYSICAL DESCRIPTION OF CORNER FOUND; EVIDENCE AND METHOD USED TO IDENTIFY OR REESTABLISH

1 1/2" O.D. iron pipe inside a 1.5' diameter iron casing at surface.

PHYSICAL DESCRIPTION OF MONUMENTS REBUILT OR PERPETUATED

Set tag L.S. 5355

SKETCH: (Include reference tie or witness points, remarks and topo of area)

Ties

- 113.72' South of nail and shiner in Power pole
- 174.13' Southeast of nail and shiner in Power pole
- 36.8' North of hinge point of Main canal roadway
- 36.0' West of overhead power lines

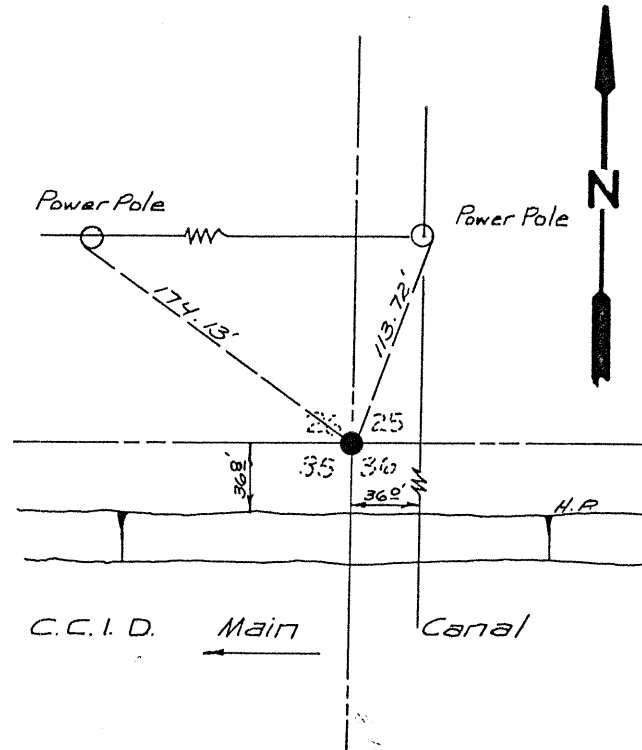

SURVEYOR'S CERTIFICATE

THIS CORNER RECORD WAS PREPARED BY ME OR UNDER MY DIRECTION IN CONFORMANCE WITH THE LAND SURVEYORS ACT ON November 20, 19 85

SIGNED: Christopher White

L.S. or XXXX No.: 5355



COUNTY SURVEYOR'S CERTIFICATE

THE CORNER RECORD WAS RECEIVED _____ 19____ AND EXAMINED AND FILED 12-9-19 85

BY: Roy Turner
TITLE: Deputy Co. Surveyor

DOCUMENT No. 2977

STATEMENT ON BACK OF SHEET

YES [] NO [X]