

CORNER RECORD

COUNTY OF Merced T. 11 S R. 11 E Mount Diablo MERIDIAN CALIFORNIA

CORNER TYPE: GOV'T. CORNER MEANDER RANCHO CONTROL OTHER
 CORNER IDENTIFICATION — DATE OF VISIT April 12, 19 83



Section Corner

CORNER — LEFT AS FOUND FOUND AND TAGGED REESTABLISHED OBLITERATED CORNER RESULT

PHYSICAL DESCRIPTION OF CORNER FOUND; EVIDENCE AND METHOD USED TO IDENTIFY OR REESTABLISH

Found 2 1/4" O.D. iron pipe with tag. L.S. 4156, as per Record of Survey Map in Book 16, Page 9, record July 18, 1978 in Merced County records.

PHYSICAL DESCRIPTION OF MONUMENTS RESULT OR PERPETUATED

Prior to Construction; reference existing section corner with swing ties to fence post. Replaced destroyed corner with 2" O.D. galvanized pipe with tagged L.S. 5190.

CALIFORNIA COORDINATE SYSTEM ORDER: FIRST SECOND THIRD
 STATIONS USED: NGS (USC & GS) STATE COUNTY OTHER STATION _____ STATION _____
 ZONE _____ ELEVATION _____ NORTHINGS (Y) _____ EASTINGS (X) _____

(Fold)

SKETCH: (Include reference tie or witness points, remarks and topo of area)

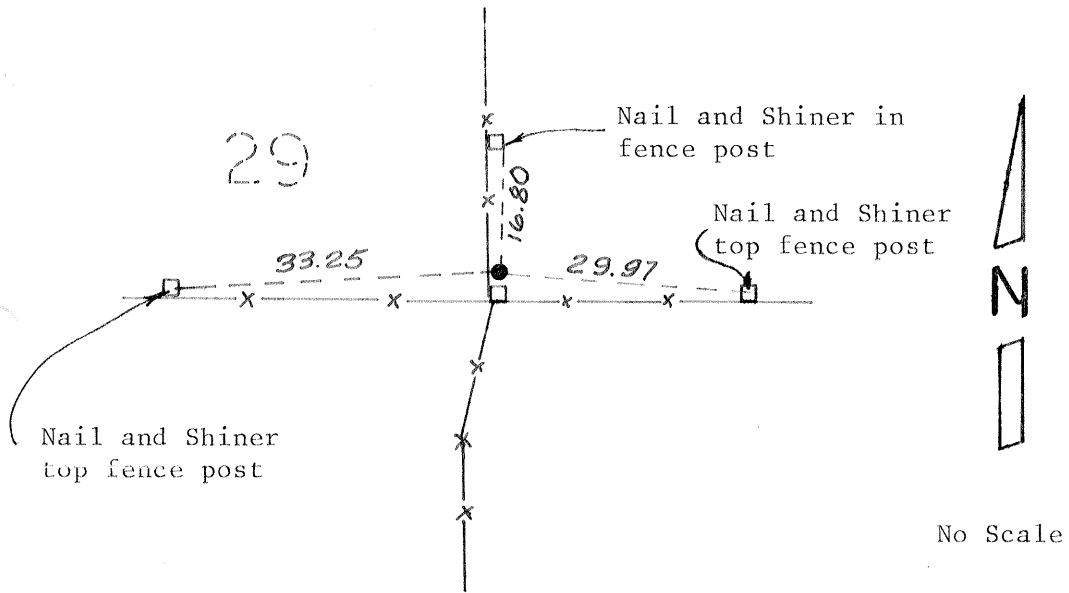

SURVEYOR'S CERTIFICATE

THIS CORNER RECORD WAS PREPARED BY ME DAVID R. SOUZA UNDER MY DIRECTION IN CONFORMANCE WITH THE LAND SURVEYORS ACT ON April 12,

SIGNED: David R. Souza
 L.S. or R.C.E. No.: 5190

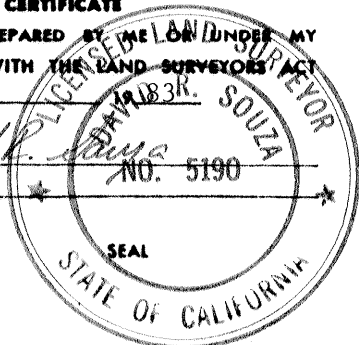

COUNTY SURVEYOR'S CERTIFICATE

THE CORNER RECORD WAS RECEIVED April 25 19 83
 AND EXAMINED AND FILED April 26 19 83
 BY: [Signature]
 TITLE: County Surveyor

DOCUMENT No. 2976A

STATEMENT ON BACK OF SHEET

YES NO