

45
CORNER RECORD

Document Number 2848

City of _____ County of MERCED, California

Brief Legal Description N.E. COR. SECT. 20, T.10S., R.11E., M.D.B.&M.



CORNER TYPE

Government Corner Control
Meander Property
Rancho Other
Date of Survey 6-7-90

**COORDINATES
(Optional)**

N. _____
E. _____
Zone _____ Datum _____
Elev. _____

Corner — Left as found Found and tagged Established Reestablished Rebuilt

Identification and type of corner found: Evidence used to identify or procedure used to establish or reestablish the corner: FOUND SPALLED AREA IN CONC. AND NAIL HOLE AND T BAR CAP LOOSE - RESET T BAR CAP WITH CONC. NAIL IN ORIGINAL HOLE. SEE STATE HIGHWAY MAP 10 MER 152, Pg 4 of 47

A description of the physical condition of the monument as found and as set or reset: MONUMENT APPEARS SOLID & UPRIGHT DOWN 1'±

SURVEYOR'S STATEMENT

This Corner Record was prepared by me or under my direction in conformance with the Land Surveyors' Act on JUNE 6 19 90.

Signed Ralph N. Scheel, Jr. L.S. or R.C.E. Number 483730

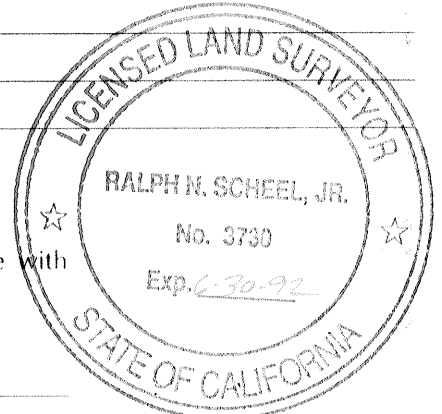

COUNTY SURVEYOR'S STATEMENT

This Corner Record was received August 19 90 and examined and filed August 22 19 90.

Signed Roy L. Turney Titled Dep. Co. Surveyor



County Surveyor's Comment COR. No 2848

17	16
20	21

7105 R. 116
MOB&M

FOUND
3x3' REDWOOD
POST WITH NAIL
AT 44 COR

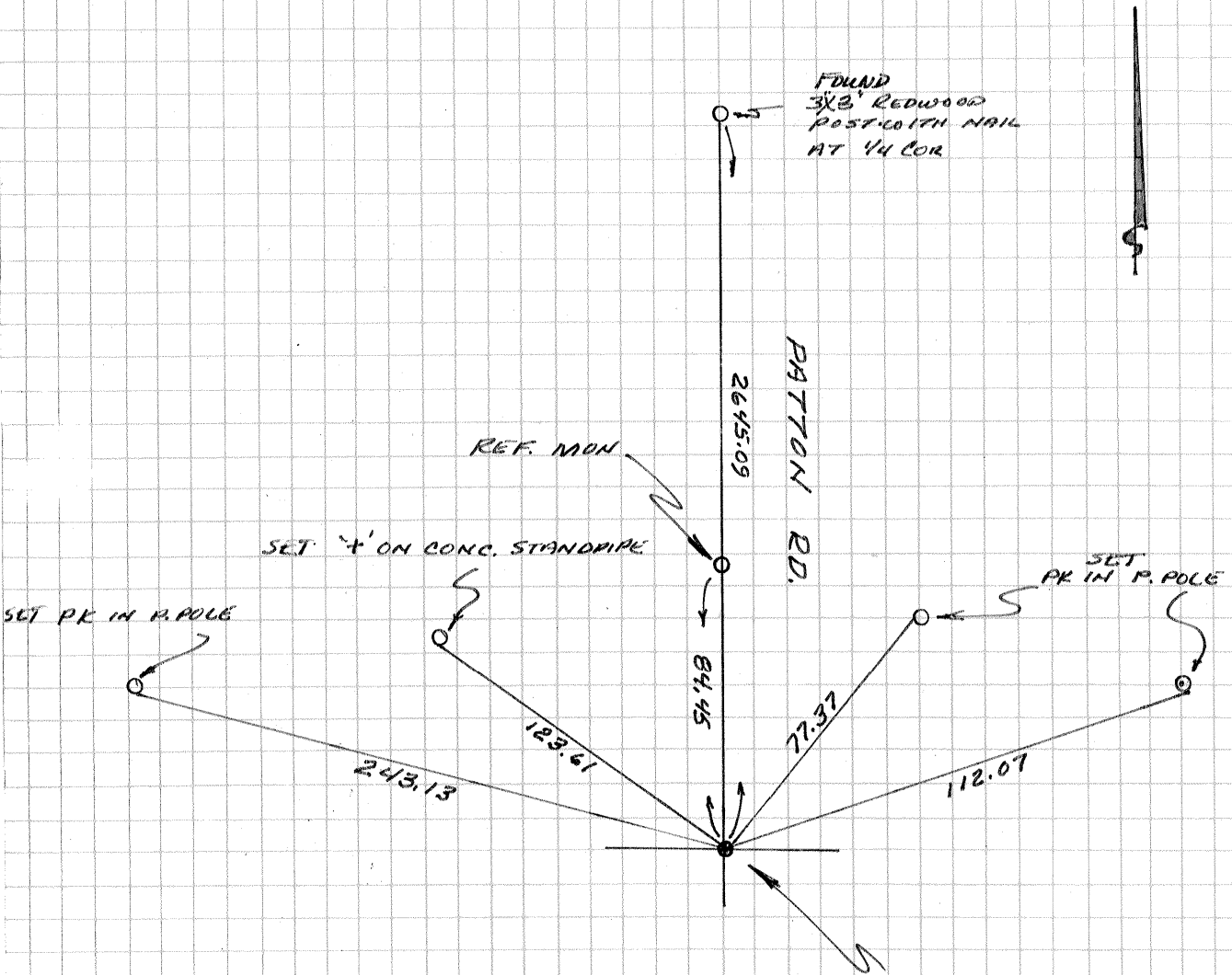

SEE STATE HIGHWAY MAP
10 MER. 152 Pg 4 of 47

FOUND SPALLED AREA
IN CONC, T'BAR CAP &
HOLE WHERE NAIL HAD
BEEN- RESET CAP
WITH NEW NAIL,
DOWN 1'¹⁵