

2778

CO. ER RECORD

COUNTY OF MERCED T. 8 SOUTH R. 9 EAST Mt. Diablo MERIDIAN CALIFORNIA
CORNER TYPE: GOV'T. CORNER MEANDER RANCHO CONTROL OTHER
CORNER IDENTIFICATION — DATE OF VISIT July 23 1979

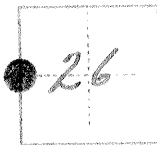

West 1/4 Cor., Sect. 26

CORNER — LEFT AS FOUND FOUND AND TAGGED REESTABLISHED OBLITERATED CORNER REBUILT

PHYSICAL DESCRIPTION OF CORNER FOUND; EVIDENCE AND METHOD USED TO IDENTIFY OR REESTABLISH

FOUND RUSTED OUT 1" O.D. IRON PIPE @ GROUND LINE IN NORTH/SOUTH FENCE LINE

PHYSICAL DESCRIPTION OF MONUMENTS REBUILT OR PERPETUATED

REPLACED WITH 1" O.D. X 28" GALVANIZED IRON PIPE TAGGED L.S. 4156

CALIFORNIA COORDINATE SYSTEM ORDER: FIRST SECOND THIRD
STATIONS USED: NGS (USC & GS) STATE COUNTY OTHER STATION _____ STATION _____
ZONE _____ ELEVATION _____ NORTHINGS (Y) _____ EASTINGS (X) _____

SKETCH: (Include reference tie or witness points, remarks and topo of area)

20.50 NORTHWEST OF NAIL & SHINER IN POWER POLE.
3.59 SOUTHEAST OF NAIL & SHINER IN FENCE POST.

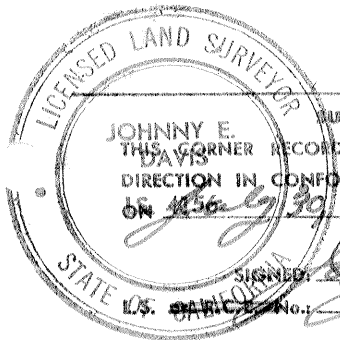
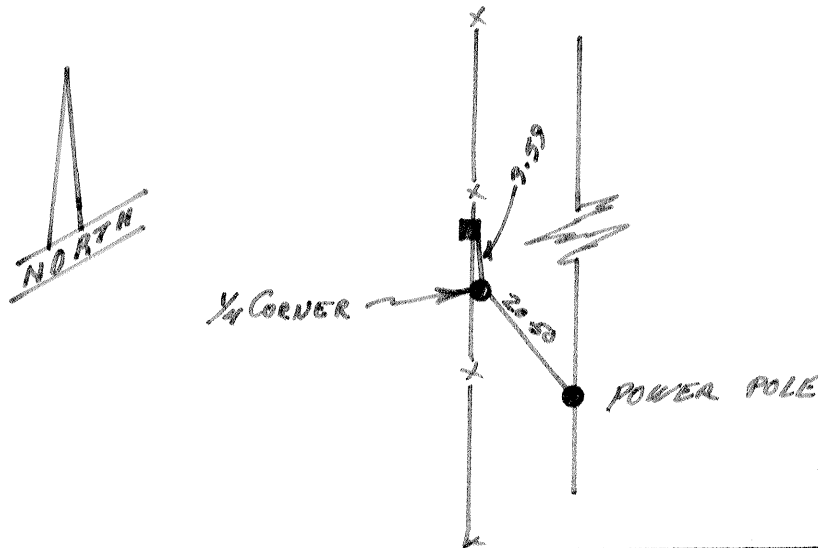

SURVEYOR'S CERTIFICATE
THIS CORNER RECORD WAS PREPARED BY ME OR UNDER MY DIRECTION IN CONFORMANCE WITH THE LAND SURVEYORS ACT OF 1956
ON July 30 1979
SIGNED: Johnny E. Davis
L.S. 4156

SEAL

COUNTY SURVEYOR'S CERTIFICATE

THE CORNER RECORD WAS RECEIVED _____ 19_____
AND EXAMINED AND FILED _____ 19_____
BY: _____
TITLE: _____
DOCUMENT No. 2771
STATEMENT ON BACK OF SHEET YES NO