

# 2677

CORNER RECORD

COUNTY OF Merced T. 9 S. R. 15 E. Mt. Diablo MERIDIAN CALIFORNIA

CORNER TYPE: GOV'T. CORNER [ ] MEANDER [ ] RANCHO [ ] CONTROL [ ] OTHER [x]  
CORNER IDENTIFICATION — DATE OF VISIT June 3 19 77

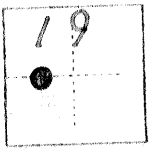

Northwest corner of Lot 22, Block 19 (Section 19) of the Bliss Ranch Subdivision on file in Volume 7 of plats at page 45 of M.C.R.

CORNER — LEFT AS FOUND [ ] FOUND AND TAGGED [x] REESTABLISHED OBLITERATED CORNER [ ] REBUILT [ ]

PHYSICAL DESCRIPTION OF CORNER FOUND; EVIDENCE AND METHOD USED TO IDENTIFY OR REESTABLISH

Found 4" x 4" redwood post at 1<sup>0</sup> feet ± below ground line.

PHYSICAL DESCRIPTION OF MONUMENTS REBUILT OR PERPETUATED

CALIFORNIA COORDINATE SYSTEM ORDER: FIRST [ ] SECOND [ ] THIRD [ ]  
STATIONS USED: NGS (USC & GS) [ ] STATE [ ] COUNTY [ ] OTHER [ ] STATION \_\_\_\_\_ STATION \_\_\_\_\_  
ZONE \_\_\_\_\_ ELEVATION \_\_\_\_\_ NORTHINGS (Y) \_\_\_\_\_ EASTINGS (X) \_\_\_\_\_

SKETCH: (Include reference tie or witness points, remarks and topo of area)

39.98 Southwest from nail & shiner in grape brace post.  
41.95 Southeast from nail & shiner in grape brace post.

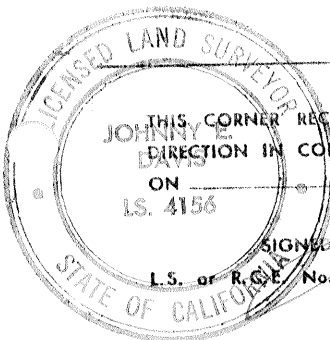

SURVEYOR'S CERTIFICATE  
THIS CORNER RECORD WAS PREPARED BY ME OR UNDER MY DIRECTION IN CONFORMANCE WITH THE LAND SURVEYORS ACT ON January 29, 19 79  
SIGNED: *Johnny E. Davis*  
L.S. or R.S.E. No.: 4156

SEAL

COUNTY SURVEYOR'S CERTIFICATE

THE CORNER RECORD WAS RECEIVED \_\_\_\_\_ 19 \_\_\_\_  
AND EXAMINED AND FILED \_\_\_\_\_ 19 \_\_\_\_  
BY: \_\_\_\_\_  
TITLE: \_\_\_\_\_  
DOCUMENT No. 2677-E  
STATEMENT ON BACK OF SHEET YES [ ] NO [ ]