

# CORNER RECORD

Document Number 2642

City of \_\_\_\_\_ County of MERCED, California

Brief Legal Description N.E. COR. SEC. 13, T. 10 S. R. 12 E.

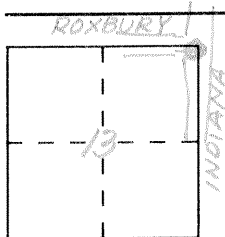

### CORNER TYPE

- Government Corner  Control
- Meander  Property
- Rancho  Other
- Date of Survey \_\_\_\_\_

### COORDINATES (Optional)

N. \_\_\_\_\_  
 E. \_\_\_\_\_  
 Zone \_\_\_\_\_ Datum \_\_\_\_\_  
 Elev. \_\_\_\_\_

Corner — Left as found  Found and tagged  Established  Reestablished  Rebuilt

Identification and type of corner found: Evidence used to identify or procedure used to establish or reestablish the corner:

Monument found and used on Parcel Map Book 78 Pg. 16  
Monument well set over pipe (SEE REVERSE SIDE FOR SWING TIES)  
POINT TIED OUT NOVEMBER 1996, PRIOR TO PAVING EFFORT BY  
MERCED COUNTY

A description of the physical condition of the monument as found and as set or reset: THESE TIES ARE FOR

THE PURPOSE OF PERPETUATING THE FOUND MONUMENTATION. NO CLAIM  
IS MADE AS TO THE RELATIONSHIP OF THE POINT OR LINE SHOWN  
HEREON TO THE BOUNDARY LOCATIONS

### SURVEYOR'S STATEMENT

This Corner Record was prepared by me or under my direction in conformance with the Land Surveyors' Act on JANUARY 16 1997.

Signed Roy L. Turney L.S. or R.C.E. Number 5523

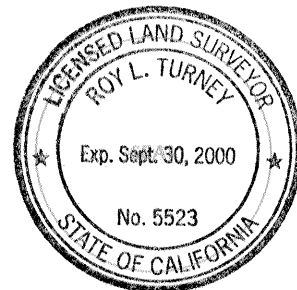

### COUNTY SURVEYOR'S STATEMENT

This Corner Record was received JANUARY 16 1997 and examined and filed JANUARY 16 1997.

Signed Roy L. Turney Title DEP. CO. SUR.

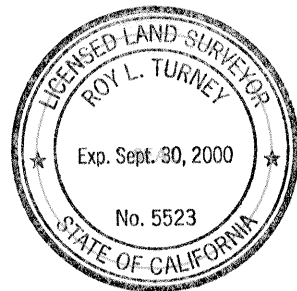

County Surveyor's Comment \_\_\_\_\_

T. 10 S. R. 12 E.

