

72631B

CO. ER RECORD

COUNTY OF Merced T. 9 S R. 14 E Mt. Diablo MERIDIAN CALIFORNIA
CORNER TYPE: GOVT. CORNER MEANDER RANCHO CONTROL OTHER
CORNER IDENTIFICATION — DATE OF VISIT June 3, 19 77



Northwest Corner of Lot 6, Block 23 (Section 23) as shown on the Map of the Bliss Ranch Subdivision on file in Volume 7 of plats at page 44, M.C.R.

CORNER — LEFT AS FOUND FOUND AND TAGGED REESTABLISHED OBLITERATED CORNER REBUILT

PHYSICAL DESCRIPTION OF CORNER FOUND; EVIDENCE AND METHOD USED TO IDENTIFY OR REESTABLISH

Found remains of old redwood post at 1.0 below road.

PHYSICAL DESCRIPTION OF MONUMENTS REBUILT OR PERPETUATED

Set 1" O.D. pipe with plastic plug marked L.S. 4156 at road surface.

CALIFORNIA COORDINATE SYSTEM ORDER: FIRST SECOND THIRD
STATIONS USED: NGS (USC & GS) STATE COUNTY OTHER STATION _____ STATION _____
ZONE _____ ELEVATION _____ NORTHINGS (Y) _____ EASTINGS (X) _____

SKETCH: (Include reference tie or witness points, remarks and topo of area)

- 124.42 Northwest from nail & shiner in power pole.
- 20.69 South from nail & shiner in 12" diameter corner fence post.
- 20.65 South from old 3" x 3" split redwood.

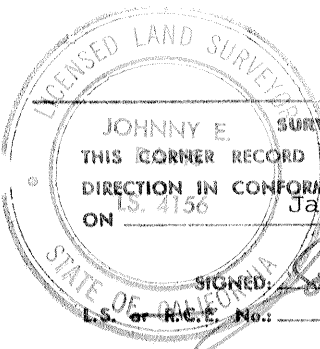

JOHNNY E. SURVEYOR'S CERTIFICATE
THIS CORNER RECORD WAS PREPARED BY ME OR UNDER MY DIRECTION IN CONFORMANCE WITH THE LAND SURVEYORS ACT
ON 18. 4156 January 31, 19 79
SIGNED: *Johnny E. Claus*
L.S. or R.C.E. No.: 4156

SEAL

COUNTY SURVEYOR'S CERTIFICATE

THE CORNER RECORD WAS RECEIVED _____ 19. _____
AND EXAMINED AND FILED _____ 19. _____
BY: _____
TITLE: _____
DOCUMENT No. 2631B
STATEMENT ON BACK OF SHEET YES NO