

CORNER RECORD

DPD-3011A (Rev. 3/98) CT# 7541-4554-2

Document Number 2560

City of _____

County of MERCED, California

Brief Legal Description N.E. CORNER SECTION 10, T.7S., R.10E., M.D.M.

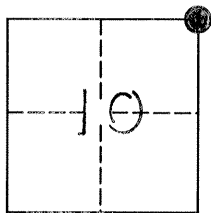

CORNER TYPE

Government Corner Control
Meander Property
Rancho Other

Date of Survey 2-24-00

COORDINATES(Optional)

N. _____
E. _____
Zone _____ NAD27 NAD83
NAD83 Epoch _____
Elevation _____
Vert. Datum: NGVD29 NAV88
Meas. Units: Metric Imperial

Corner - Left as found Established Reestablished Rebuilt

Identification and type of corner found: Evidence used to identify or procedure used to establish or reestablish the corner:
FOUND BRASS CAP STAMPED "U.S.G.L.O.", DOWN 2 FEET, PER RECORD OF SURVEY RECORDED IN BOOK 20 OF SURVEYS, PAGE 10, M. C. R.

A description of the physical condition of the monument as found and as set or reset:
FOUND IN GOOD CONDITION. SET 3 SWING TIES.

SURVEYOR'S STATEMENT

This Corner Record was prepared by me or under my direction in conformance with the Land Surveyor's Act on FEB. 24, 2000.

Signed John H. Asher P.L.S. Number 7221
For the State of California
Department of Transportation

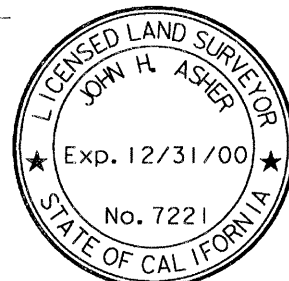

COUNTY SURVEYOR'S STATEMENT

This Corner Record was received AUG. 16, 2000 and examined and filed SEPT. 5, 2000.

Signed Roy L. Turney P.L.S. or R.C.E. Number 5523

Title DEPUTY CO. SURVEYOR

County Surveyor's Comment _____

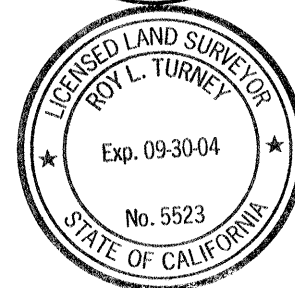

NE Cor. Sec. 10, T.7S., R.10E. M.D.M.

FOUND BRASS CAP STAMPED
"U.S.G.L.O." DOWN 2 FT.
IN W'LY. SHOULDER OF
STATE HWY. 165

(LANDER AVE.)

STATE
HWY. 165



50.76'

Set nail & shiner
in junction pole

66.17'

108.26'

Dirt Road

Set nail & shiner
in junction pole

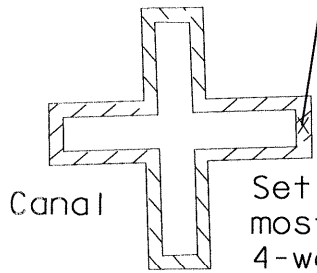

Canal

Set chisel "X" in
most E'ly wall of
4-way head gate

Canal



Dirt Road

TO
STEVINSON

50.76' W. OF N&S IN JUNCTION POLE
108.26' NW OF N&S IN JUNCTION POLE
66.17' N. OF CHISEL "X" IN HEADWALL