

2381

COI IR RECORD

COUNTY OF Merced T. 10S R. 14E M.D.B. & M. MERIDIAN CALIFORNIA
CORNER TYPE: GOV'T. CORNER MEANDER RANCHO CONTROL OTHER
CORNER IDENTIFICATION - DATE OF VISIT January 1978



30 feet South of North 1/4 corner

CORNER - LEFT AS FOUND FOUND AND TAGGED REESTABLISHED OBLITERATED CORNER REBUILT

PHYSICAL DESCRIPTION OF CORNER FOUND; EVIDENCE AND METHOD USED TO IDENTIFY OR REESTABLISH

Found and tagged I.S. 4156, a 2-1/4" iron rod @ 0.3 ft. below road surface

PHYSICAL DESCRIPTION OF MONUMENTS REBUILT OR PERPETUATED

CALIFORNIA COORDINATE SYSTEM ORDER: FIRST SECOND THIRD
STATIONS USED: NGS (USC & GS) STATE COUNTY OTHER STATION _____ STATION _____
ZONE _____ ELEVATION _____ NORTHINGS (Y) _____ EASTINGS (X) _____

SKETCH: (Include reference tie or witness points, remarks and topo of area)

- 30.00 ft. South of 1/4 corner position
- 28.28 ft. North of nail & shiner in power pole
- 188.62 ft. Northeast of nail & shiner in power pole at the intersection of Jefferson Road and Anchor Street

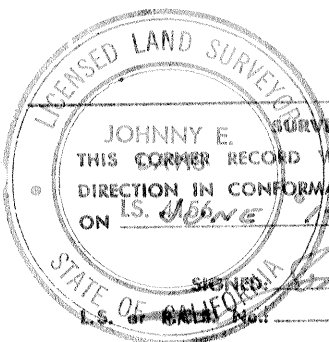

JOHNNY E. DAVIS SURVEYOR'S CERTIFICATE
THIS CORNER RECORD WAS PREPARED BY ME OR UNDER MY DIRECTION IN CONFORMANCE WITH THE LAND SURVEYORS ACT ON I.S. 4156 1978

SIGNED: Johnny E. Davis
4156

SEAL

COUNTY SURVEYOR'S CERTIFICATE

THE CORNER RECORD WAS RECEIVED _____ 19_____
AND EXAMINED AND FILED _____ 19_____
BY: _____

TITLE: _____

DOCUMENT No. 2381

STATEMENT ON BACK OF SHEET

YES NO