

No 237

CORNER RECORD

COUNTY OF MERCED T. 8 S. R. 12 E. M.D. MERIDIAN CALIFORNIA

CORNER TYPE: GOVT. CORNER MEANDER RANCHO CONTROL OTHER

CORNER IDENTIFICATION — DATE OF VISIT Sept 19 80

3	5
---	---

Southwest corner of section 35.

Purpose: To replace corner destroyed during County Road reconstruction.

CORNER — LEFT AS FOUND FOUND AND TAGGED REESTABLISHED OBLITERATED CORNER REBUILT

PHYSICAL DESCRIPTION OF CORNER FOUND; EVIDENCE AND METHOD USED TO IDENTIFY OR REESTABLISH

Found 2" iron pipe. Used swing ties to locate

PHYSICAL DESCRIPTION OF MONUMENTS REBUILT OR PERPETUATED

Set 2" inside diameter iron pipe in survey encasement. Tagged "Merced County Surveyor"

CALIFORNIA COORDINATE SYSTEM ORDER: FIRST SECOND THIRD

STATIONS USED: NGS (USC & GS) STATE COUNTY OTHER STATION _____ ELEVATION _____

ZONE _____ NORTHINGS (Y) _____ EASTINGS (X) _____

SKETCH: (Include reference tie or witness points, remarks and topo of area)

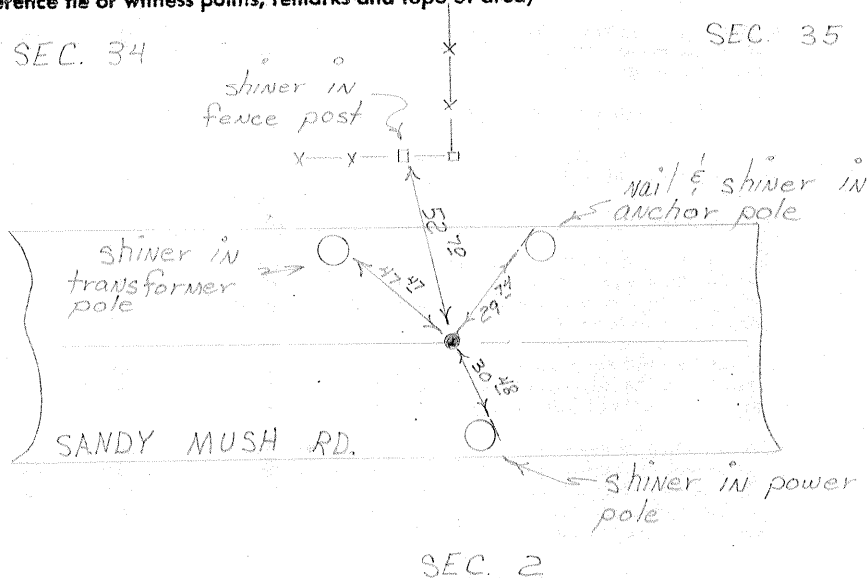

SURVEYOR'S CERTIFICATE

THIS CORNER RECORD WAS REBUILT BY ME OR UNDER MY DIRECTION IN CONFORMANCE WITH THE LAND SURVEYORS' ACT ON 2/19/80 No. 14639

SIGNED: [Signature]

L.S. or R.C.E. No.: _____

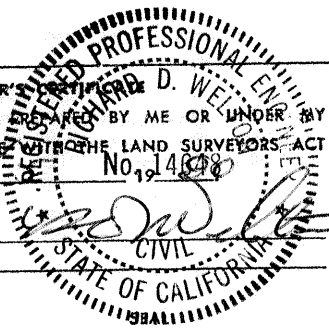

COUNTY SURVEYOR'S CERTIFICATE

THE CORNER RECORD WAS RECEIVED 2/19/80 AND EXAMINED AND FILED No. 14639

BY: [Signature]

TITLE: CIVIL

DOCUMENT No. 2377

STATEMENT ON BACK OF SHEET

YES NO

