

NO. 231 4

CO. ER RECORD

COUNTY OF Merced T. 9S R. 14E Mt. Diablo MERIDIAN CALIFORNIA

CORNER TYPE: GOV'T. CORNER [] MEANDER [] RANCHO [] CONTROL [] OTHER [x]

CORNER IDENTIFICATION - DATE OF VISIT March 29, 1976



Northwest corner of Lot 4, Block 34, (Section 34) as shown on the Map of the Bliss Ranch Subdivision on file in Volume 7 of plats at Page 50, M.C.R.

CORNER - LEFT AS FOUND [x] FOUND AND TAGGED [] REESTABLISHED OBLITERATED CORNER [] REBUILT []

PHYSICAL DESCRIPTION OF CORNER FOUND; EVIDENCE AND METHOD USED TO IDENTIFY OR REESTABLISH

Found 3 x 3 redwood at 1.25 below road surface with 1" O.D. pipe with County Surveyor tague at 0.85 feet below road surface

PHYSICAL DESCRIPTION OF MONUMENTS REBUILT OR PERPETUATED

CALIFORNIA COORDINATE SYSTEM ORDER: FIRST [] SECOND [] THIRD [] STATIONS USED: NGS (USC & GS) [] STATE [] COUNTY [] OTHER [] STATION _____ STATION _____ ZONE _____ ELEVATION _____ NORTHINGS (Y) _____ EASTINGS (X) _____

SKETCH: (include reference tie or witness points, remarks and topo of area)

28.84 North from nail & shiner in power pole
40.82 Northwest from paint mark on guy wire

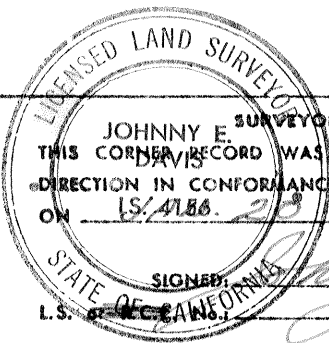

SURVEYOR'S CERTIFICATE
JOHNNY E. DAVIS
THIS CORNER RECORD WAS PREPARED BY ME OR UNDER MY DIRECTION IN CONFORMANCE WITH THE LAND SURVEYORS ACT
ON 15/4/88 23 19 80
SIGNED: Johnny E. Davis
L.S. 4188 4156

COUNTY SURVEYOR'S CERTIFICATE
THE CORNER RECORD WAS RECEIVED Feb 25 19 80
AND EXAMINED AND FILED 19
BY: Walter Mitchell
TITLE:
DOCUMENT No. 2316A
STATEMENT ON BACK OF SHEET YES [] NO []

SEAL