

#2313

COLLAR RECORD

COUNTY OF Merced T 9S R 14E Mt. Diablo MERIDIAN CALIFORNIA  
CORNER TYPE: GOVT. CORNER  MEANDER  RANCHO  CONTROL  OTHER   
CORNER IDENTIFICATION — DATE OF VISIT 5-20-1976



Northwest corner of Lot 24, Block 23, (Section 23) as shown on Map of the Bliss Ranch Subdivision on file in Volume 7 of Plats, at page 44, M.C.R.

CORNER — LEFT AS FOUND  FOUND AND TAGGED  REESTABLISHED OBLITERATED CORNER  REBUILT

PHYSICAL DESCRIPTION OF CORNER FOUND; EVIDENCE AND METHOD USED TO IDENTIFY OR REESTABLISH

Found 4 x 4 redwood 0.4 below road surface with 60<sup>d</sup> nail in center

PHYSICAL DESCRIPTION OF MONUMENTS REBUILT OR PERPETUATED

CALIFORNIA COORDINATE SYSTEM ORDER: FIRST  SECOND  THIRD   
STATIONS USED: NGS (USC & GS)  STATE  COUNTY  OTHER  STATION \_\_\_\_\_ STATION \_\_\_\_\_  
ZONE \_\_\_\_\_ ELEVATION \_\_\_\_\_ NORTHINGS (Y) \_\_\_\_\_ EASTINGS (X) \_\_\_\_\_

SKETCH: (Include reference tie or witness points, remarks and topo of area)

- 38.49 Southeast from nail & shiner in power pole.
- 28.82 Northwest from nail & shiner in railroad tie.
- 48.49 Northwest from nail & shiner in fence post.

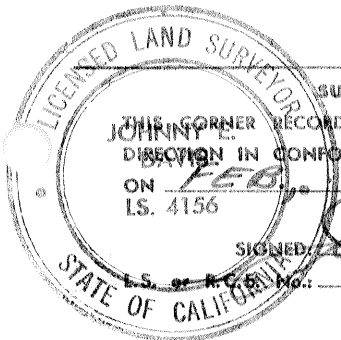

SURVEYOR'S CERTIFICATE  
THIS CORNER RECORD WAS PREPARED BY ME OR UNDER MY DIRECTION IN CONFORMANCE WITH THE LAND SURVEYORS ACT  
ON FEB 9 1976  
L.S. 4156  
SIGNED: *Johnny E. Hayes*  
L.S. or A.C.S. No.: 4156

SEAL

COUNTY SURVEYOR'S CERTIFICATE

THE CORNER RECORD WAS RECEIVED \_\_\_\_\_ 19\_\_\_\_\_  
AND EXAMINED AND FILED \_\_\_\_\_ 19\_\_\_\_\_  
BY: \_\_\_\_\_  
TITLE: \_\_\_\_\_

DOCUMENT No. 2313

STATEMENT ON BACK OF SHEET

YES  NO