

**CORNER RECORD**

Document Number 2294  
City of \_\_\_\_\_ County of Merced, California

Brief Legal Description 1/4 COR. between Section 9 and Section 10, T6S, R11E, MDM

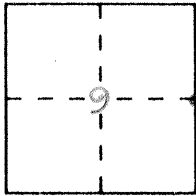

**CORNER TYPE**

**COORDINATES  
(Optional)**

10 Government Corner  Control   
Meander  Property   
Rancho  Other   
Date of Survey JUNE 23, 1998

N. \_\_\_\_\_  
E. \_\_\_\_\_  
Zone \_\_\_\_\_ Datum \_\_\_\_\_  
Elev. \_\_\_\_\_

Corner — Left as found  Found and tagged  Established  Reestablished  Rebuilt

Identification and type of corner found: Evidence used to identify or procedure used to establish or reestablish the corner: 3/4" IP with orange plastic plug illegible, no reference

A description of the physical condition of the monument as found and as set or reset: good, except plastic plug is illegible

**SURVEYOR'S STATEMENT**

This Corner Record was prepared by me or under my direction in conformance with the Land Surveyors' Act on June 23, 1998.

Signed Robin L. Wickline L.S. or R.C.E. Number LS 7026  
Expires 6/30/02

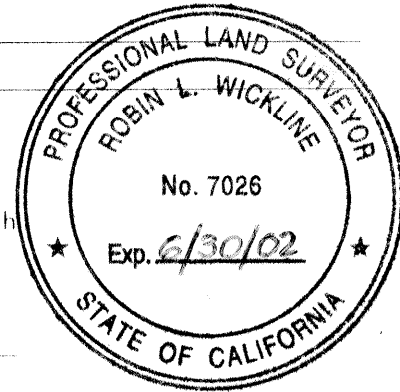

**COUNTY SURVEYOR'S STATEMENT**

This Corner Record was received JULY 20, 1998 and examined and filed JULY 27, 1998.

Signed Roy L. Turney Title DEP. CO. SUR.

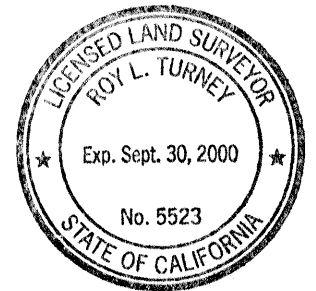

County Surveyor's Comment \_\_\_\_\_

SR 98 0077

**LEGEND:**

- FOUND 3/4" I.P. W/ORANGE P/D ILLEGIBLE (down)
- SET CONCRETE NAIL W/BRASS TAG "CAL TRANS"

**NOTE:** All distances shown are measured ground distances.

NO SCALE



50 Sycamore Road  
(ABANDONED)

1<sup>ST</sup> AVE. SOUTH

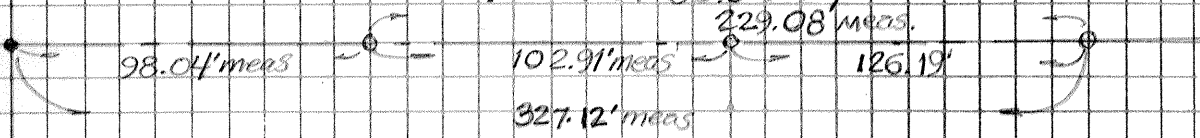

SECTION 9

SECTION 10  
T 6 S R 1 E M 0 M