

CORNER RECORD

Document Number 2291-22, AAA

City of _____

County of Merced, California

Brief Legal Description Lot 274 Delhi State Land Settlement

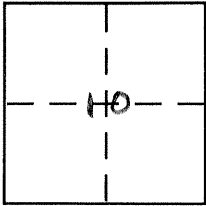

6/11

CORNER TYPE

- Government Corner Control
- Meander Property
- Rancho Other
- Date of Survey 1-06-05

COORDINATES (Optional)

- N. _____
- E. _____
- Zone _____ NAD27 NAD83
- NAD83 Epoch _____
- Elev. _____
- Vert. Datum: NGVD29 NAVD88
- Meas. Units: Metric Imperial

Corner - Left as found Found and tagged Established Reestablished Rebuilt

Identification and type of corner found: Evidence used to identify or procedure used to establish or reestablish the corner:

See sketch

Note: Fences do not match property lines.

A description of the physical condition of the monument as found and as set or reset:

See sketch

SURVEYOR'S STATEMENT

This Corner Record was prepared by me or under my direction in conformance with the Land Surveyor's Act on 2-11-05

Signed [Signature] P.L.S or R.C.E. No. _____

COUNTY SURVEYOR'S STATEMENT

This Corner Record was received 2-11-05

and examined and filed 2-23-05

Signed Roy L. Turney P.L.S or R.C.E. No. 5523

Title Dep. Co. Surveyor

County Surveyor's Comment _____

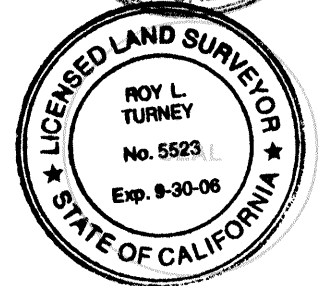
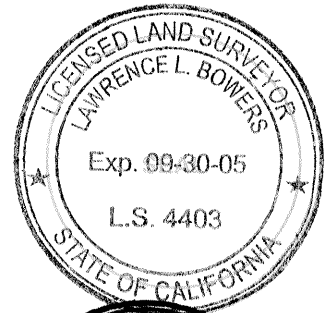

0 50 100 200 400

SCALE: 1" = 200'



265

G.R.S. 36
M.C.R.

270

FOUND 4"x4" DOWN 2.6'
SET 3/4" IRON PIPE IN 4"x4"

233

FOUND 5/8" ROD

N. 52°29'46" E. 700.04'
(N. 52°30' E. 700'(1))

S. 50°02' E.
160.00' & (1)

S. 30°45'16" E. 285.98'
(S. 30°51' E. 285.70'(1))

274

FOUND 3/4" IRON PIPE

N. 52°30' E. 700.00' & (1)
680.00'

273

PETALUMA
S. 37°30' E.

277

BASIS OF BEARINGS & (1)
12 P.M. 30
M.C.R.

284

450.06'
(450'(1))
A VENUE

FOUND 4"x4"

279

287

285

FOUND 4"x4" DOWN 2.8'
SET 3/4" IRON PIPE IN 4"x4"

286

(S. 0°06' E. 317.10'(1))

LEGEND:

- Set 3/4" iron pipe with tag L.S. 4403
- C.R. Calculated from record
- M.C.R. Merced County Records

SECOND AVENUE

SOUTH

BASIS OF BEARINGS:

S. 37°30' E. for the centerline of Petaluma Avenue, as shown on the map entitled "Delhi State Land Settlement", Volume 8, Official Plats, Page 5, Merced County Records.

Reference:

(1) Delhi State Land Settlement, 8 O.P. 5, M.C.R.