

CORNER RECORD

Document Number 2267-0, P, Q, R, S, T

City of _____

County of Merced, California

Brief Legal Description Lots 3 & 4 as shown on Stevinson Colony Subd. #10, Vol 13 Maps Pg 42 Merced Records
SECTION 19, T7S, R10E, M.D. 13FM.

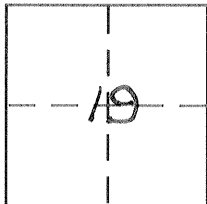

CORNER TYPE

Government Corner Control
Meander Property
Rancho Other
Date of Survey August 2004

COORDINATES (Optional)

N. _____
E. _____
Zone _____ NAD27 NAD83
NAD83 Epoch _____
Elev. _____
Vert. Datum: NGVD29 NAVD88
Meas. Units: Metric Imperial

Corner -- Left as found Found and tagged Established Reestablished Rebuilt

Identification and type of corner found: Evidence used to identify or procedure used to establish or reestablish the corner:

A description of the physical condition of the monument as found and as set or reset:

1/2" x 30" iron pipe tagged LS 3664

SURVEYOR'S STATEMENT

This Corner Record was prepared by me or under my direction in conformance with the Land Surveyor's Act on August 2004

Signed John E. Coplantz P.L.S or R.C.E. No. 3664

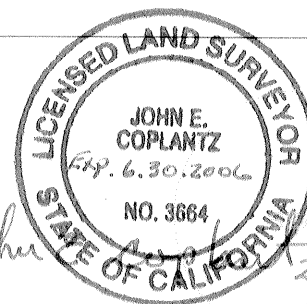

COUNTY SURVEYOR'S STATEMENT

This Corner Record was received 9-9-04

and examined and filed 10-5-04

Signed Roy L. Turney P.L.S or R.C.E. No. 5523

Title Dep. Co. Surveyor

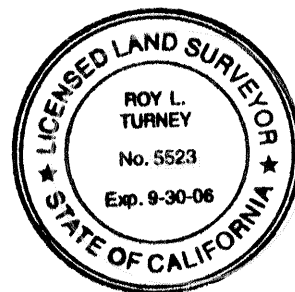

County Surveyor's Comment _____

12" IP (3) Cemetery Road

LOT 5

RCE
Fd 3/4" IP 28159 (3)

30'

20'

26'

Keaton Road

N 00° 00' 36" E 1290.38' 1290'(1)

20'

20'

LOT 29

649.86'
650'(1)

LOT 4

649.91'
650'(1)

N 89° 50' 37" E 2639.93' 2640'(1)

LOT 30

649.86'
650'(1)

LOT 3

649.91'
650'(1)

N 00° 00' 27" E 1290.31' 1290'(1)

1290'(1)

THIRD AVENUE

N 89° 50' 14" E 5279.33' 5280'(4)

N 00° 00' 18" E 1290.24' 1290'(1)

Fd 1/2" IP 153664

LOT 31

649.86'
650'(1)

LOT 2

649.92'
650'(1)

N 00° 00' 10" E 1290.17' 1290'(1)

Fd 2x3" hole & very small
rod splinters. set
1/2"x30" centered
LS 3664

LOT 32

649.86'
650'(1)

LOT 1

649.91'
650'(1)

North 1290.10' 1290'(1)

Fd 1 1/2" IP (2)

20'

20'

(North Assumed) 1320.09(2) & M.

Fd 3/4" IP 153664 (2)

Wainwright Road

Fd 1 3/8" IP (2)

30'

30'

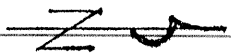

● Found & used monument, as noted
○ set 1/2" x 30" iron pipe, topped LS 3664

Not to Scale

Survey for owner Vincent Roman
1/2" x 30" were set on Lots 3 & 4 August 2004 by John E Coplantz, Land Surveyor No 3664
Lots 1 & 2 were monumented July 2001. Lots 1 to 4 are shown on Stevinson Colony Subdivision No. 10,
Volume 3 of Maps Page 42, Merced County Records.

Rp = Prorata

References

- (1) Stevinson Colony Sub 10, Vol 3 Maps Pg 42, Merced Co. Rec
- (2) Vol 23 Record Survey Pg. 8, Merced Co. Records
- (3) Vol. 32 Record Survey Pg 1, Merced Co. Records