

CORNER RECORD

COUNTY OF MERCED T. 5 S. R. 12 E. M.D.B. # \_\_\_\_\_ MERIDIAN CALIFORNIA

CORNER TYPE: GOVT. CORNER  MEANDER  RANCHO  CONTROL  OTHER

CORNER IDENTIFICATION - DATE OF VISIT JULY 9, 1991

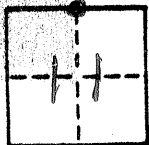

NORTH 1/4 CORNER SECTION 11 5/12

MONTE VISTA AVE. E. & W.

CORNER - LEFT AS FOUND  FOUND AND TAGGED  REESTABLISHED OBLITERATED CORNER  REBUILT

PHYSICAL DESCRIPTION OF CORNER FOUND; EVIDENCE AND METHOD USED TO IDENTIFY OR REESTABLISH

FOUND 1/2" IRON PIPE - L.S. 4379 - DOWN 1"

PHYSICAL DESCRIPTION OF MONUMENTS REBUILT OR PERPETUATED

CALIFORNIA COORDINATE SYSTEM ORDER: FIRST  SECOND  THIRD   
STATIONS USED: NGS (USC & GS)  STATE  COUNTY  OTHER  STATION \_\_\_\_\_  
ZONE \_\_\_\_\_ ELEVATION \_\_\_\_\_ NORTHINGS (N) \_\_\_\_\_ EASTINGS (X) \_\_\_\_\_

SKETCH: (Include reference tie or witness points, remarks and topo of area)

5.0' S. OF C/L ROAD E. & W.  
30.00' N. OF 1/2" I.P. - L.S. 4379 - DOWN 10"  
7.50' W. OF PEACH ROW S.  
22.50' E. OF ALMOND ROW S.  
112.48' NW OF @ NE/S PP.  
28.0' N. OF PL E. & W. - OMIT 1ST POLE E.  
54.35' NW OF 4" STEEL GATE POST.  
56.75' NE OF 4" STEEL GATE POST.

See P.M. BK. 60 PG. 3

J.N. 91-041

F.B. 587/4

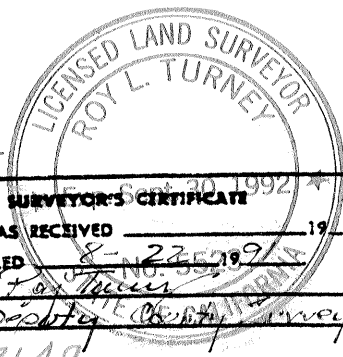

SURVEYOR'S CERTIFICATE  
THIS CORNER RECORD WAS PREPARED BY ME OR UNDER MY DIRECTION IN CONFORMANCE WITH THE LAND SURVEYORS ACT ON JULY 9, 1991

SIGNED William O. Gentry

L.S. or R.C.E. No. 2737  
EXPIRES: 6-30-1992

COUNTY SURVEYOR'S CERTIFICATE  
THE CORNER RECORD WAS RECEIVED \_\_\_\_\_ 19\_\_\_\_ AND EXAMINED AND FILED 8-23-1991

BY: For [Signature]  
TITLE: Deputy County Surveyor

DOCUMENT No. # 2149

STATEMENT ON BACK OF SHEET YES  NO