

N^o 197

CORNER RECORD

NTY OF MERCED T. 9 S R. 13 E M.D.B & M. MERIDIAN CALIFORNIA
CORNER TYPE: GOV'T. CORNER MEANDER RANCHO CONTROL OTHER
CORNER IDENTIFICATION — DATE OF VISIT SEPT. 1976

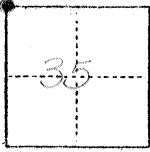

SECTION CORNER: NORTH WEST CORNER SECTION 35

CORNER — LEFT AS FOUND FOUND AND TAGGED REESTABLISHED OBLITERATED CORNER REBUILT

PHYSICAL DESCRIPTION OF CORNER FOUND; EVIDENCE AND METHOD USED TO IDENTIFY OR REESTABLISH

1/2" IRON PIPE WAS DESTROYED WHEN ROAD WAS REBUILT,
DUG DOWN 3'
USED SWING TIES IN BOOK 60 PG 34 M.C.R.D. TO RESET

PHYSICAL DESCRIPTION OF MONUMENTS REBUILT OR PERPETUATED

Brought up with 2" Iron Pipe with tag 13,760 set in Survey Encasement.

CALIFORNIA COORDINATE SYSTEM ORDER: FIRST SECOND THIRD
STATIONS USED: NGS (USC & GS) STATE COUNTY OTHER STATION _____ STATION _____
ZONE _____ ELEVATION _____ NORTHINGS (Y) _____ EASTINGS (X) _____

(Fold)

SKETCH: (Include reference tie or witness points, remarks and topo of area)

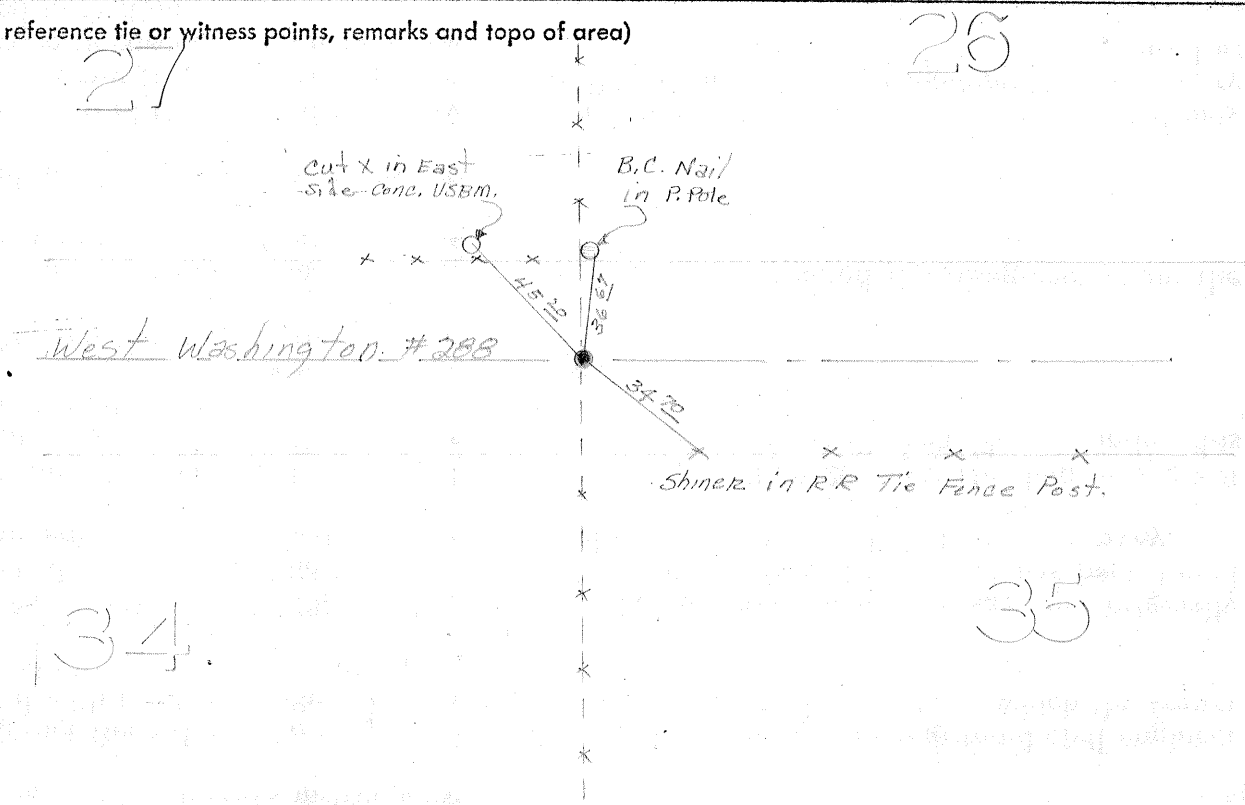

SURVEYOR'S CERTIFICATE

THIS CORNER RECORD WAS PREPARED BY ME OR UNDER MY DIRECTION IN CONFORMANCE WITH THE LAND SURVEYORS ACT OF _____ 19____.

SIGNED: _____

L.S. or R.C.E. No.: _____

SEAL

COUNTY SURVEYOR'S CERTIFICATE

THE CORNER RECORD WAS RECEIVED _____ 19____ AND EXAMINED AND FILED _____ 19____.

BY: _____

TITLE: _____

DOCUMENT No. 1977

STATEMENT ON BACK OF SHEET

YES NO