

# CORNER RECORD

COUNTY OF Merced T. 10 S. R. 13 E. M.D.B. & MERIDIAN CALIFORNIA

CORNER TYPE: GOVT. CORNER  MEANDER  RANCHO  CONTROL  OTHER

CORNER IDENTIFICATION — DATE OF VISIT August 26 1983

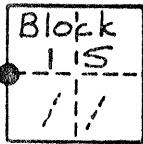

Northwest corner of the South half of Block 15 of "Subdivision No. 5 of Chowchilla Ranch" recorded at 5 o.p. 30 M.C.R. (west quarter corner Section 11 10/13)

CORNER — LEFT AS FOUND  FOUND AND TAGGED  REESTABLISHED OBLITERATED CORNER  RESULT

**PHYSICAL DESCRIPTION OF CORNER FOUND; EVIDENCE AND METHOD USED TO IDENTIFY OR REESTABLISH**

Found a 1 1/4" O.D. iron pipe 0.7' below ground surface.  
Location and description match "Caltrans" ties. Set tag L.S. 5355

**PHYSICAL DESCRIPTION OF MONUMENTS RESULT OR PERPETUATED**

CALIFORNIA COORDINATE SYSTEM ORDER: FIRST  SECOND  THIRD   
 STATIONS USED: NGS (USC & GS)  STATE  COUNTY  OTHER  STATION \_\_\_\_\_ STATION \_\_\_\_\_  
 ZONE \_\_\_\_\_ ELEVATION \_\_\_\_\_ NORTHINGS (Y) \_\_\_\_\_ EASTINGS (X) \_\_\_\_\_

**SKETCH: (Include reference tie or witness points, remarks and topo of area)**

New Ties

- 86.96 East of California Division of Highways tag in power pole (87.12)
- 116.64 Southwest of nail & shiner in power pole
- 154.24 Northeast of nail & shiner in power pole
- 31.0 West of north/south pole line
- 30.0 East of pole line south

( ) Record per "Caltrans" ties.

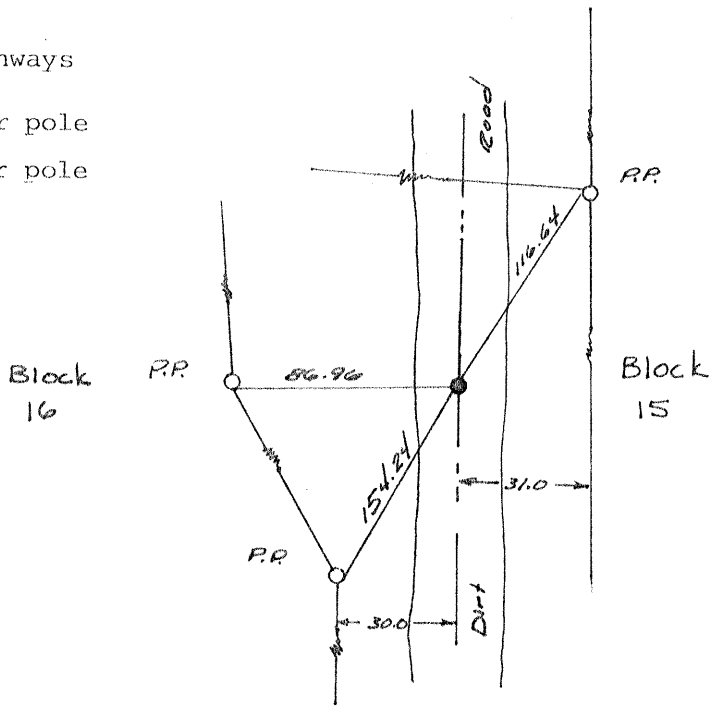

**SURVEYOR'S CERTIFICATE**  
 THIS CORNER RECORD WAS PREPARED BY ME OR UNDER MY DIRECTION IN CONFORMANCE WITH THE LAND SURVEYORS ACT ON August 29 1983  
 SIGNED: Christopher L. White L.S. 5355  
 L.S. of R.C.E. No. 5355

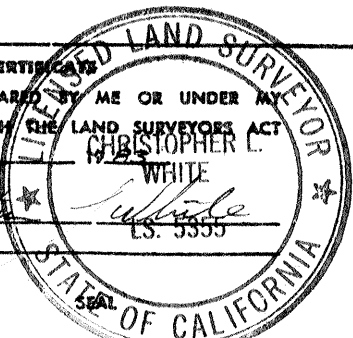

**COUNTY SURVEYOR'S CERTIFICATE**  
 THE CORNER RECORD WAS RECEIVED \_\_\_\_\_ 19\_\_\_\_ AND EXAMINED AND FILED \_\_\_\_\_ 19\_\_\_\_  
 BY: [Signature]  
 TITLE: County Surveyor  
 DOCUMENT No. 1792

STATEMENT ON BACK OF SHEET YES  NO