

COUNTY OF MERCED T. 11S R. 12E MDBE MERIDIAN CALIFORNIA

CORNER TYPE: GOV'T. CORNER MEANDER RANCHO CONTROL OTHER

CORNER IDENTIFICATION — DATE OF VISIT JAN 7, 1977

DR PERRY CP
E. BOYLE
B. GARICA



N 1/4, 14 VALERIA & CENTER
(CITY OF DOS PALOS)

CORNER — LEFT AS FOUND FOUND AND TAGGED REESTABLISHED OBLITERATED CORNER REBUILT

PHYSICAL DESCRIPTION OF CORNER FOUND; EVIDENCE AND METHOD USED TO IDENTIFY OR REESTABLISH

FOUND A CALIFORNIA STATE DIVISION OF HIGHWAYS BRASS CAP
3" DN IN A WELL WITH COVER DESCRIBED AS A MERCED CO. MOUNT
IN 1970 TIES

PHYSICAL DESCRIPTION OF MONUMENTS REBUILT OR PERPETUATED

PLACED RCB TAG # 14344 ON BRASS CAP WITH EPOXY

CALIFORNIA COORDINATE SYSTEM ORDER: FIRST SECOND THIRD
STATIONS USED: NGS (USC & GS) STATE COUNTY OTHER STATION _____ STATION _____
ZONE _____ ELEVATION _____ NORTHINGS (Y) _____ EASTINGS (X) _____

SKETCH: (Include reference tie or witness points, remarks and topo of area)

4129 SE OF "4" ON CURB RET.
3591 NE OF "4" ON CONC CURB RET.
5552 SW OF "4" ON CURB RET.
5670 NNW OF O IN PP
4109 MW OF O IN PP

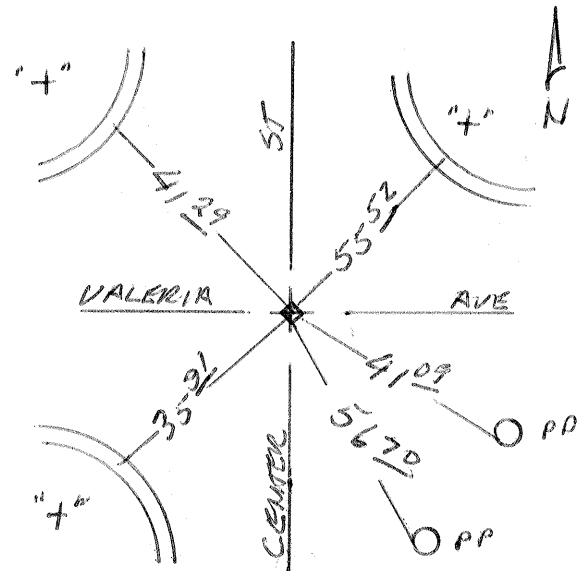

SURVEYOR'S CERTIFICATE

THIS CORNER RECORD WAS PREPARED BY ME OR UNDER MY
DIRECTION IN CONFORMANCE WITH THE LAND SURVEYORS ACT
ON JANUARY 7, 1977 No. 14344
FOR THE COUNTY OF MERCED

SIGNED: Gaydon K. Peterson

L.S. or R.C.E. No.: 14344

SEAL

COUNTY SURVEYOR'S CERTIFICATE

THE CORNER RECORD WAS RECEIVED FEB 11, 1977
AND EXAMINED AND FILED NO. 13760 1977

TITLE: CIVIL ENGINEER

DOCUMENT No. 1781

STATEMENT ON BACK OF SHEET

YES NO