

L. JEESE  
LANE  
GORMAN  
R. NANTO

# CORNER RECORD

COUNTY OF MERCED T. 11 S R. 12 E MD Base MERIDIAN CALIFORNIA  
CORNER TYPE: GOVT. CORNER  MEANDER  RANCHO  CONTROL  OTHER   
CORNER IDENTIFICATION - DATE OF VISIT 23 APRIL 1982

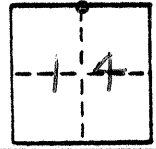

N/4 COR. SEC. 14 11/12  
VALERIA & FOLSOM AVES. (CENTRAL AVE, DOS PALOS)

CORNER - LEFT AS FOUND  FOUND AND TAGGED  REESTABLISHED OBLITERATED CORNER  REBUILT

PHYSICAL DESCRIPTION OF CORNER FOUND; EVIDENCE AND METHOD USED TO IDENTIFY OR REESTABLISH  
FOUND CALIFORNIA STATE DIVISION OF HIGHWAYS BRASS MONUMENT 3" DOWN  
IN WALL; USING 1970 TIES BY M. GUFFEY.

PHYSICAL DESCRIPTION OF MONUMENTS REBUILT OR PERPETUATED  
LEFT AS FOUND. RETIED AS BELOW

CALIFORNIA COORDINATE SYSTEM ORDER: FIRST  SECOND  THIRD   
STATIONS USED: MGS (USC & GS)  STATE  COUNTY  OTHER  STATION \_\_\_\_\_ STATION \_\_\_\_\_  
ZONE \_\_\_\_\_ ELEVATION \_\_\_\_\_ NORTHINGS (Y) \_\_\_\_\_ EASTINGS (X) \_\_\_\_\_

SKETCH: (Include reference tie or witness points, remarks and topo of area)

- 41<sup>26</sup> NW of O in P.P.
- 56<sup>81</sup> NW of O in J.P.
- 35<sup>99</sup> NE of X in S. END  
S.W. CORB RETURN
- 43<sup>68</sup> SE of X in N. END  
N.W. CORB RETURN
- 55<sup>50</sup> SW of X in CENTER  
N.E. CORB RETURN

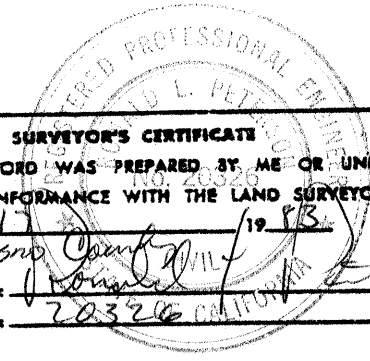
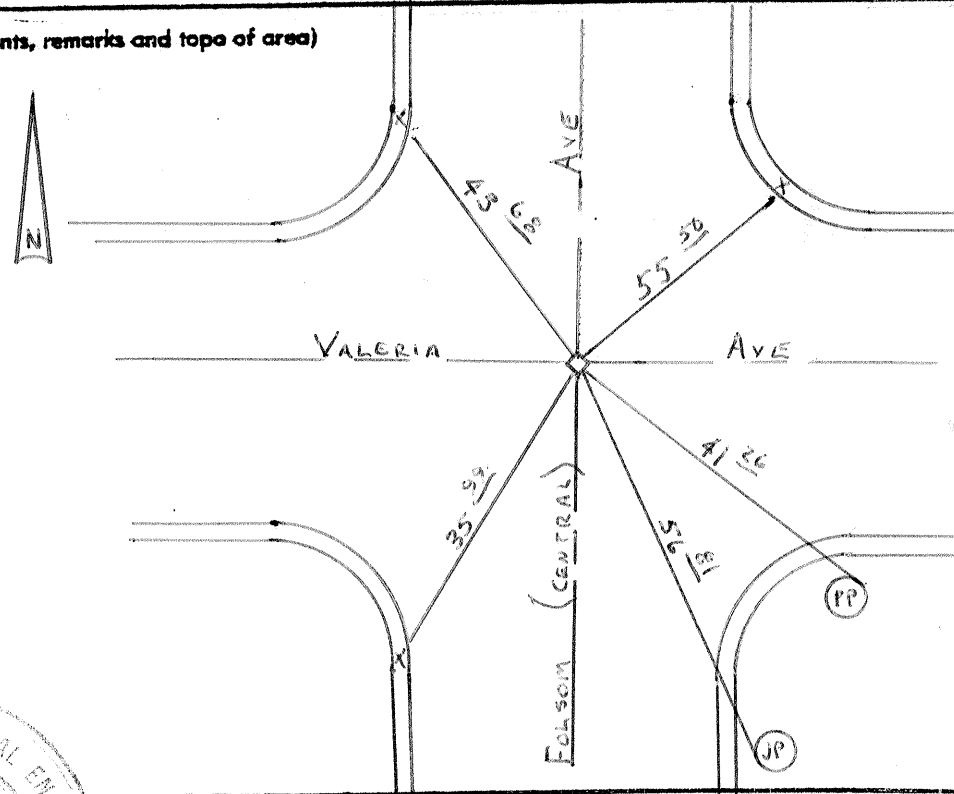

**SURVEYOR'S CERTIFICATE**  
THIS CORNER RECORD WAS PREPARED BY ME OR UNDER MY DIRECTION IN CONFORMANCE WITH THE LAND SURVEYORS ACT ON Feb 17 1983  
SIGNED: [Signature]  
L.S. or R.C.E. No.: 20326 CALIFORNIA

**COUNTY SURVEYOR'S CERTIFICATE**  
THE CORNER RECORD WAS RECEIVED \_\_\_\_\_ 19\_\_\_\_\_  
AND EXAMINED AND FILED MAY 10 1983  
BY: [Signature]  
TITLE: \_\_\_\_\_  
DOCUMENT No. 1781  
STATEMENT ON BACK OF SHEET YES  NO

SEAL