

**CORNER RECORD**

Document Number 1771"00"  
City of LOS BANOS County of MERCED, California

Brief Legal Description Survey Mon. on south side of State Hwy. 152 at approximately 422' east of Paradise Lane centerline in SEC 22, T10 S, R10 E, MDM

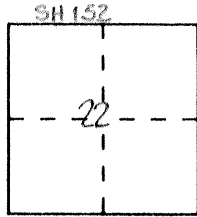

**CORNER TYPE**

**COORDINATES (Optional)**

Government Corner  Control   
Meander  Property   
Rancho  Other   
Date of Survey 6/04/1998

N. \_\_\_\_\_  
E. \_\_\_\_\_  
Zone \_\_\_\_\_ Datum \_\_\_\_\_  
Elev. \_\_\_\_\_

Corner — Left as found  Found and tagged  Established  Reestablished  Rebuilt

Identification and type of corner found: Evidence used to identify or procedure used to establish or reestablish the corner: Searched, found nothing. Monument destroyed by road construction. Reestablished from found RP's per Corner Record 1771-0-0, filed May 26, 1996, MCR.

A description of the physical condition of the monument as found and as set or reset: Set 1" IP with yellow plastic plug "CALTRANS" (flush in soil @ back of concrete curb)

**SURVEYOR'S STATEMENT**

This Corner Record was prepared by me or under my direction in conformance with the Land Surveyors' Act on July 8 1998.

Signed Robin L. Wickline L.S. or R.C.E. Number 7026  
Expires 6/30/02



**COUNTY SURVEYOR'S STATEMENT**

This Corner Record was received 7-20 1998 and examined and filed JULY 27, 1998.

Signed Roy L. Turney Title DEP. CO. SUR.



County Surveyor's Comment \_\_\_\_\_

SR 980219

REF: CORNER RECORD 1771-0-0, FILED MAY 26, 1996, MCR  
73 PM 8 MCR

CITY of LOS BANOS  
SEC 22, T10S, R10E MDM

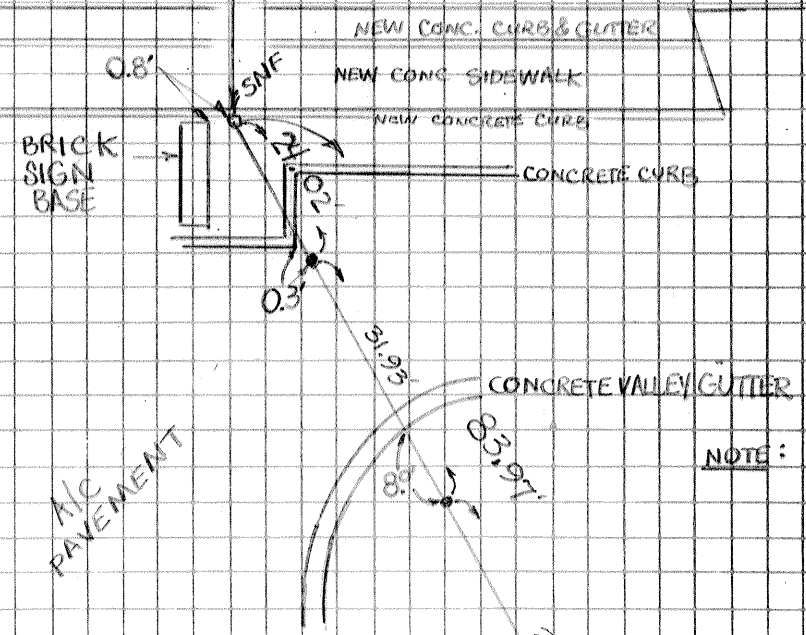
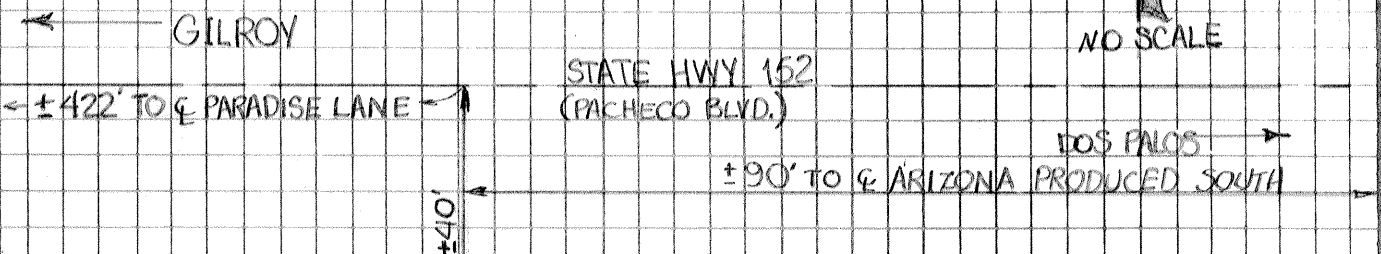

NOTE: ALL DISTANCES SHOWN  
ARE RECORD AND  
MEASURED GROUND  
DISTANCES IN FEET  
UNLESS NOTED ±

**LEGEND:**

- ± DENOTES APPROXIMATE DISTANCE  
(ACTUAL CENTERLINES NOT ESTABLISHED)
- DENOTES SET 1" IP WITH YELLOW  
PLASTIC PLUG "CALTRANS" (flush in soil)
- DENOTES FOUND PK NAIL and SHINER  
REFERENCE POINTS PER CR 1771-0-0 MCR
- SNF DENOTES SEARCHED, NOTHING FOUND

