

CORNER RECORD

Document Number _____

City of _____

County of MERCED, California

Brief Legal Description SOUTH 1/4 CORNER SECTION 34 T.8S., R.13E.

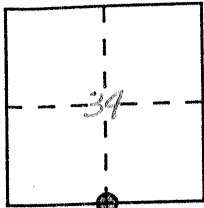

SANDY MUSH

CORNER TYPE

Government Corner Control
 Meander Property
 Rancho Other
 Date of Survey AUGUST 1997

COORDINATES (Optional)

N. _____
 E. _____
 Zone _____ Datum _____
 Elev. _____

Corner — Left as found Found and tagged Established Reestablished Rebuilt

Identification and type of corner found: Evidence used to identify or procedure used to establish or reestablish the corner:
FD. 1" I.P. TAGGED MERCED COUNTY SURVEYOR 03 DOWN (SEE REVERSE SIDE FOR SWING TIES) POINT TIED OUT AUGUST 1997 PRIOR TO A PAVING EFFORT BY MERCED COUNTY. MONUMENT WELL SET OVER 1" I.P.

A description of the physical condition of the monument as found and as set or reset: THESE TIES ARE FOR THE PURPOSE OF PERPETUATING THE FOUND MONUMENTATION NO CLAIM IS MADE AS TO THE RELATIONSHIP OF THE POINT OR LINE SHOWN HEREIN TO THE BOUNDARY LOCATIONS

SURVEYOR'S STATEMENT

This Corner Record was prepared by me or under my direction in conformance with the Land Surveyors' Act on 10-1 1997.

Signed Roy L. Turney L.S. or R.C.E. Number 5523

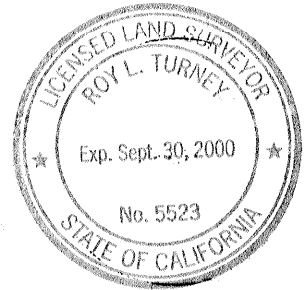

COUNTY SURVEYOR'S STATEMENT

This Corner Record was received 10-1- 1997 and examined and filed 10-1- 1997.

Signed Roy L. Turney Title DEP. CO. SUR.

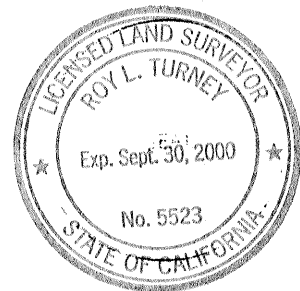

County Surveyor's Comment _____

SEC. 34
T.8S. R.13E.

SHINER IN FENCE
POST.

SHINER IN
POWER POLE

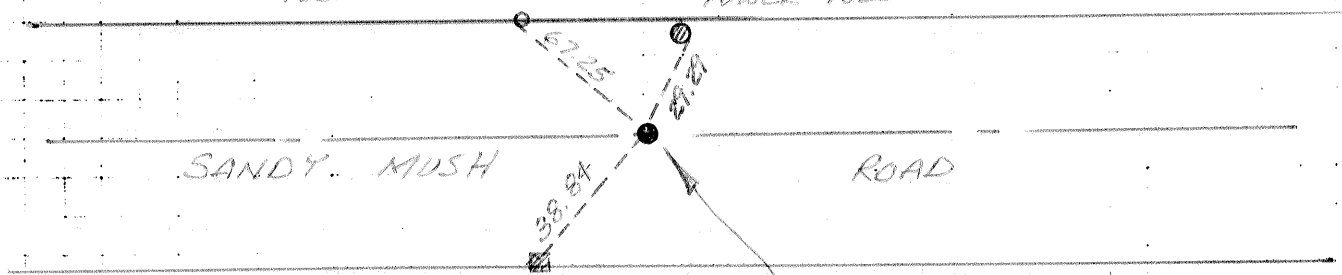

SANDY MUSH

ROAD

SHINER IN TOP
FENCE POST.

SOUTH 1/4 CORNER SECTION 34
FD. 1" I.P. TAGGED MERCED
COUNTY SURVEYOR SET
MONUMENT WELL OVER 1" I.P.