

CORNER RECORD

Agency Index 1370-RRR

Document Number _____

City of MERCED

County of MERCED, California

Brief Legal Description MONUMENT AT LOTS 56 AND 81, PER 77 O.P. 40-51, M.C.R.

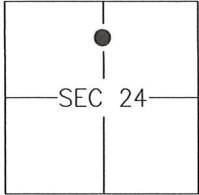

CORNER TYPE

- Government Corner Control
 Meander Property
 Rancho Other

Date of Survey 2019-04-01

COORDINATES (Optional)

- N. _____ E. _____
 Elevation _____
 Units Metric U.S. Survey Foot
 Horizontal Datum _____
 Zone _____ Epoch Date _____
 Vertical Datum: _____
 Complies with Public Resources Code §§8801-8819
 Complies with Public Resources Code §§8890-8902

PLS Act Ref.: 8765(d) 8771 8773 Other: _____

Corner/Monument: Left as found Established Rebuilt Pre-Construction
 Found and tagged Reestablished Referenced Post-Construction

Narrative of corner identified and monument as found and set or reset:
 See sheet #2 for description(s):

SURVEYOR'S STATEMENT

This Corner Record was prepared by me or under my direction in conformance with
 the Land Surveyor's Act on 19 APRIL, 2019.
 Signed [Signature] P.L.S. or R.C.E. No.: 8040

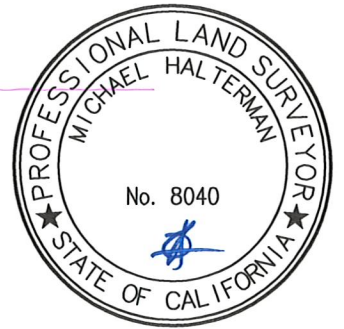

COUNTY SURVEYOR'S STATEMENT

This Corner Record was received APRIL 23, 2019 and examined
 and filed APRIL 23, 2019.
 Signed Zach T. Janz P.L.S. or R.C.E. No.: 8664
 Title COUNTY SURVEYOR



County Surveyor's Comment _____

