

CORNER RECORD

Document Number 1363{3}

City of _____

County of MERCED, California

Brief Legal Description SOUTHWEST CORNER OF SECTION 33, TOWNSHIP 7 SOUTH, RANGE 13 EAST, M.D.B.&M.

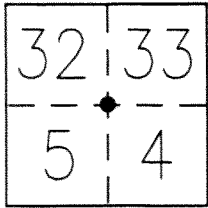

CORNER TYPE

Government Corner Control
 Meander Property
 Rancho Other
 Date of Survey MARCH 12, 2013

COORDINATES (Optional)

N. _____
 E. _____
 Zone _____ NAD27 NAD83
 NAD83 Epoch _____
 Elev. _____
 Vert. Datum: NGVD29 NAVD88
 Meas. Units: Metric Imperial

Corner - Left as found Found and tagged Established Reestablished Rebuilt

Identification and type of corner found: Evidence used to identify or procedure used to establish or reestablish the corner:
FOUND 1" IRON PIPE TAGGED "MERCED CO. SURVEYOR" AND REMEASURED TO TIES SET FOR CORNER RECORD 1363
DATED 1-09-08. ACCEPTED AS THE SOUTHWEST CORNER OF SECTION 33, TOWNSHIP 7 SOUTH, RANGE 13 EAST.
EXISTING TIES IN GOOD CONDITION. MONUMENT WILL LIKELY BE DESTROYED BY OVERLAY OF GURR ROAD.

A description of the physical condition of the monument as found and as set or reset: SEE PAGE 2

SURVEYOR'S STATEMENT

This Corner Record was prepared by me or under my direction in conformance with
 the Land Surveyor's Act on July 9, 2013
 Signed [Signature] P.L.S. or ~~P.C.E.~~ No. 4895

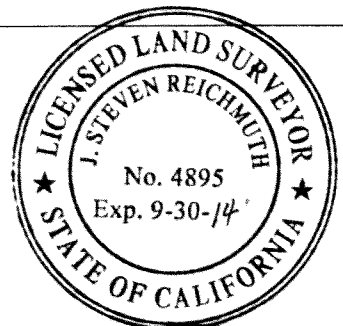

COUNTY SURVEYOR'S STATEMENT

This Corner Record was received July 9, 2013
 and examined and filed July 9, 2013
 Signed [Signature] P.L.S. or ~~P.C.E.~~ No. 4895
 Title County Surveyor



County Surveyor's Comment _____

SECTION 32
T.7 S., R.13 E.

SECTION 33
T.7 S., R.13 E.

30'

30'

FOUND CHISELED "X" IN
CONCRETE WINGWALL.

FOUND 1" (I.D.) IRON PIPE TAGGED "MERCED
COUNTY SURVEYOR" FOR S.W. CORNER
OF SECTION 33 PER 108 PM 28.

DICKENSON

BRIDGE

FERRY ROAD

30'

30'

FOUND CHISELED "X" IN
CONCRETE WINGWALL.

48.78'

43.75'

58.20'

43.20'

30'

30'

FOUND NAIL & SHINER IN S.W.
SIDE OF POWER POLE.

FOUND SHINER AND TIN IN
TOP OF FENCE POST.

SECTION 5
T.8 S., R.13 E.

SECTION 4
T.8 S., R.13 E.

30'

30'

30'

30'

GURR ROAD

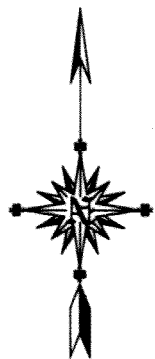

SCALE 1"=40'