

CORNER RECORD

Document Number 1356-83

City of MERCED

County of MERCED, California

Brief Legal Description PROPERTY CORNER ON THE EAST LINE OF DEED, DOC # 2006-039349, M.C.O.R.

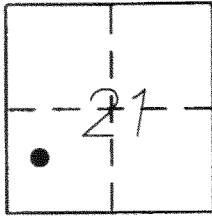

T7S, R14E

CORNER TYPE

Government Corner Control
Meander Property
Rancho Other
Date of Survey 9-24-2012

COORDINATES (Optional)

N. _____
E. _____
Zone NAD27 NAD83
NAD83 Epoch _____
Elev. _____
Vert. Datum: NGVD29 NAVD88
Meas. Units: Metric Imperial

Corner - Left as found Found and tagged Established Reestablished Rebuilt

Identification and type of corner found: Evidence used to identify or procedure used to establish or reestablish the corner:
3/4" IRON PIPE TAGGED L.S. 7621, AS SHOWN ON 46 R.S. 28, M.C.R., ON THE EAST LINE AND APPROXIMATELY
383' FROM NORTH LINE OF DEED RECORDED AS DOC # 2006-039349, M.C.O.R.

MONUMENT WAS DESTROYED WITH CONSTRUCTION PROJECT.

A description of the physical condition of the monument as found and as set or reset: _____
SET 3/4" IRON PIPE TAGGED LS 7621
PER CORNER RECORD 1356-B3 FILED ON JULY 3, 2012

SURVEYOR'S STATEMENT

This Corner Record was prepared by me or under my direction in conformance with
the Land Surveyor's Act on SEPTEMBER 24, 2012

Signed David D. Heinrich P.L.S or R.C.E. No. 7621



COUNTY SURVEYOR'S STATEMENT

This Corner Record was received September 26, 2012
and examined and filed September October 1, 2012

Signed J. Steven Reichmuth P.L.S or R.C.E. No. 4895

Title Acting County Surveyor

County Surveyor's Comment _____

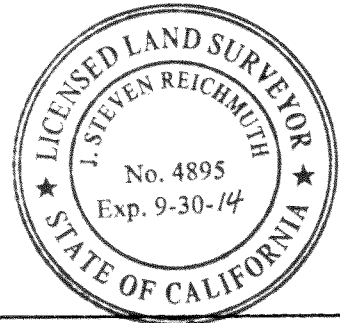

NORTH LINE DOC # 206-039349, M.C.O.R.

MONTE
GROSSO DRIVE

FOUND 3/4" IRON
TAGGED LS 4403

FOUND X ON MOW STRIP

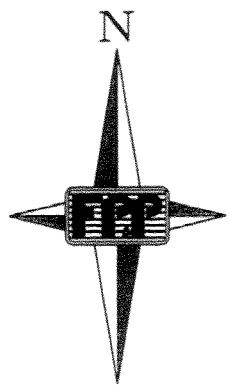

SCALE 1" = 60'

FOUND 3/4" IRON PIPE
TAGGED RCE 6888

8 O.P. 23 (16)

406.05'

8 O.P. 23 (17)

377.67'
383.76'

PARSONS
AVENUE

8 O.P. 23 (24)

FOUND 3/4" IRON PIPE
TAGGED LS 3212

SET 3/4" IRON PIPE
TAGGED LS 7621

210.20'

8 O.P. 23 (25)