

# CORNER RECORD

Document Number 1355-5555

City of MERCED

County of MERCED, California

Brief Legal Description NORTHEAST PROPERTY CORNER OF MERCED CITY PARK SITE, 2 R.S. 122, M.C.R.

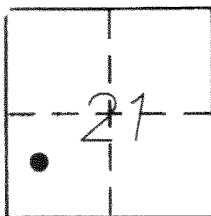

T7S, R14E

### CORNER TYPE

Government Corner  Control

Meander  Property

Rancho  Other

Date of Survey 9-24-2012

### COORDINATES (Optional)

N. \_\_\_\_\_

E. \_\_\_\_\_

Zone \_\_\_\_\_ NAD27  NAD83

NAD83 Epoch \_\_\_\_\_

Elev. \_\_\_\_\_

Vert. Datum: NGVD29  NAVD88

Meas. Units: Metric  Imperial

Corner - Left as found  Found and tagged  Established  Reestablished  Rebuilt

Identification and type of corner found: Evidence used to identify or procedure used to establish or reestablish the corner:

3/4" IRON PIPE OPEN, AS SHOWN ON 2 R.S. 122, M.C.R, AT THE NORTHEAST CORNER OF  
MERCED CITY PARK SITE.

MONUMENT WAS DESTROYED WITH CONSTRUCTION PROJECT.

A description of the physical condition of the monument as found and as set or reset: \_\_\_\_\_

SET 3/4" IRON PIPE TAGGED LS 7621

PER CORNER RECORD 1355-SSSS FILED ON JUNE 12, 2012

### SURVEYOR'S STATEMENT

This Corner Record was prepared by me or under my direction in conformance with the Land Surveyor's Act on SEPTEMBER 24, 2012

Signed David D. Heinrich P.L.S or R.C.E. No. 7621



### COUNTY SURVEYOR'S STATEMENT

This Corner Record was received September 26, 2012

and examined and filed October 1, 2012

Signed J. Steven Reichmuth P.L.S or R.C.E. No. 4895

Title Acting County Surveyor

County Surveyor's Comment \_\_\_\_\_

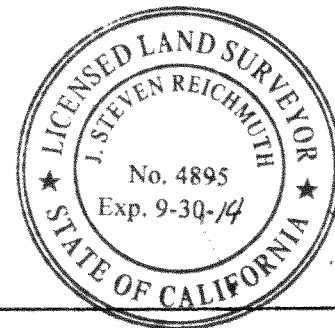

NORTH LINE DOC # 206-039349, M.C.O.R.

FOUND X ON  
CONCRETE  
LIGHT BASE

MONTE

GROSSO DRIVE

FOUND 3/4" IRON  
TAGGED LS 4403

191.64'  
148.93'

195.01'

SET X ON MOW STRIP

382.47'

8 O.P. 28  
(16)

FOUND 3/4" IRON PIPE  
TAGGED RCE 6888

N

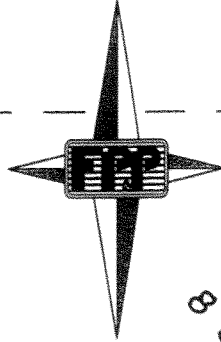

SCALE 1" = 60'

8 O.P. 28  
(17)

PARSONS  
AVENUE

SET 3/4" IRON PIPE  
TAGGED LS 7621

443.79'

8 O.P. 28  
(24)

FOUND 3/4" IRON PIPE  
TAGGED LS 3212

8 O.P. 28  
(25)

MERCED CITY  
PARK SITE  
2 R.S. 122