

CORNER RECORD

Document Number 1347A

City of _____

County of MERCED, California

Brief Legal Description Corners Lots 45, 69

Bradleys Add. No. 2 ZOP 1/2

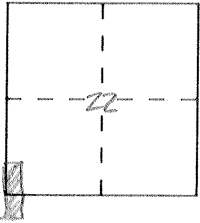

CORNER TYPE

- Government Corner
- Meander
- Rancho
- Date of Survey _____
- Control
- Property
- Other

COORDINATES (Optional)

N. _____
 E. _____
 Zone _____ Datum _____
 Elev. _____

Corner — Left as found Found and tagged Established Reestablished Rebuilt

Identification and type of corner found: Evidence used to identify or procedure used to establish or reestablish the corner:

See sketch

A description of the physical condition of the monument as found and as set or reset:

See sketch

SURVEYOR'S STATEMENT

This Corner Record was prepared by me or under my direction in conformance with the Land Surveyors' Act on May 23 2000

Signed [Signature] L.S. or R.C.E. Number L.S. 4403

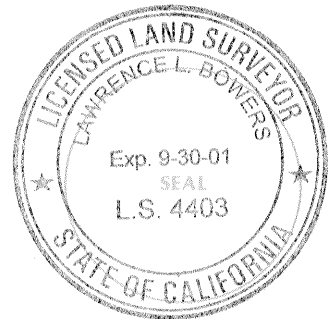

COUNTY SURVEYOR'S STATEMENT

This Corner Record was received 5-23 2000 and examined

and filed JUNE 23 19-2000

Signed [Signature] Title DEP CO SURVEYOR



County Surveyor's Comment _____

SOUTH BEAR CREEK DRIVE
ROBINSON LATERAL

FOUND 3/4" IRON PIPE, L.S. 3812

12.5' SOUTH AND 1.6' EAST OF BLOCK FENCE CORNER

FOUND 3/4" IRON PIPE (TOP CENTER OF CANAL BANK)



SECTION CORNER FOUND CONCRETE MONUMENT WITH 1/2" IRON ROD AT "T" FENCE CORNER

FOUND 1/2" IRON PIPE AT "T" FENCE CORNER

SEC. 22
 SEC. 27
 SEC. 28

SET 3/4" IRON PIPE (AT FENCE CORNER)

FOUND 3/4" IRON PIPE, L.S. 3733 IN MONUMENT WELL

FOUND 1 1/2" RUSTED OUT IRON PIPE SET 3/4" IRON PIPE, L.S. 4403 (0.6' SOUTH OF FENCE CORNER)

STRETCH

DRIVE

0 100 200 300 400 800

SCALE: 1" = 400'