

**CORNER RECORD**

Document Number 1330-VVV

City of \_\_\_\_\_

County of MERCED, California

Brief Legal Description LOTS 9 & 10 Block 2 S.O.P. 10M.C.R.

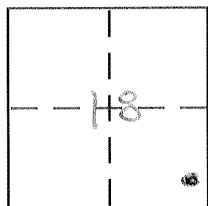

**CORNER TYPE**

Government Corner  Control   
Meander  Property   
Rancho  Other   
Date of Survey 2-27-07

**COORDINATES (Optional)**

N. \_\_\_\_\_  
E. \_\_\_\_\_  
Zone \_\_\_\_\_ NAD27  NAD83   
NAD83 Epoch \_\_\_\_\_  
Elev. \_\_\_\_\_  
Vert. Datum: NGVD29  NAVD88   
Meas. Units: Metric  Imperial

Corner - Left as found  Found and tagged  Established  Reestablished  Rebuilt

Identification and type of corner found: Evidence used to identify or procedure used to establish or reestablish the corner:

SEE SKETCH

A description of the physical condition of the monument as found and as set or reset:

SEE SKETCH

**SURVEYOR'S STATEMENT**

This Corner Record was prepared by me or under my direction in conformance with the Land Surveyor's Act on 3/26/07

Signed [Signature] P.L.S or R.C.E. No. \_\_\_\_\_

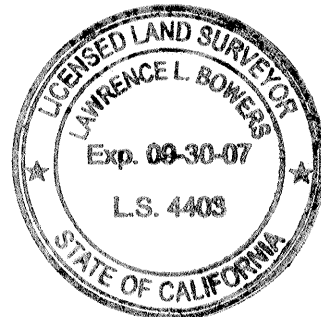

**COUNTY SURVEYOR'S STATEMENT**

This Corner Record was received March 27, 2007

and examined and filed March 30, 2007

Signed [Signature] P.L.S or R.C.E. No. 4895

Title Dep. County Surveyor

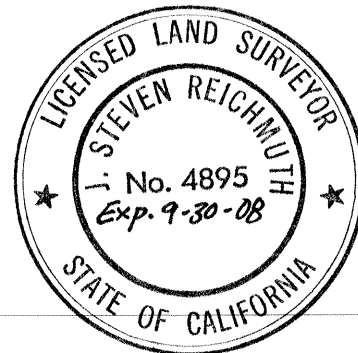

County Surveyor's Comment \_\_\_\_\_

SANTA FE AVENUE

S. 44°47'37" E. 480.08' (480.00')(1) (N. 44°50'00" W. 480.04')(3)

FOUND 1 1/4" IRON PIPE (3)  
WITH COUNTY SURVEYORS  
BRASS TAG IN MONUMENT BOX

FOUND 1 1/4" IRON PIPE, NO TAG,  
IN MONUMENT BOX (2)(3)

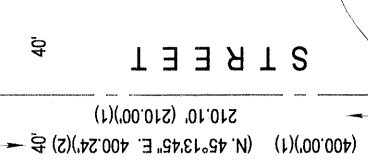
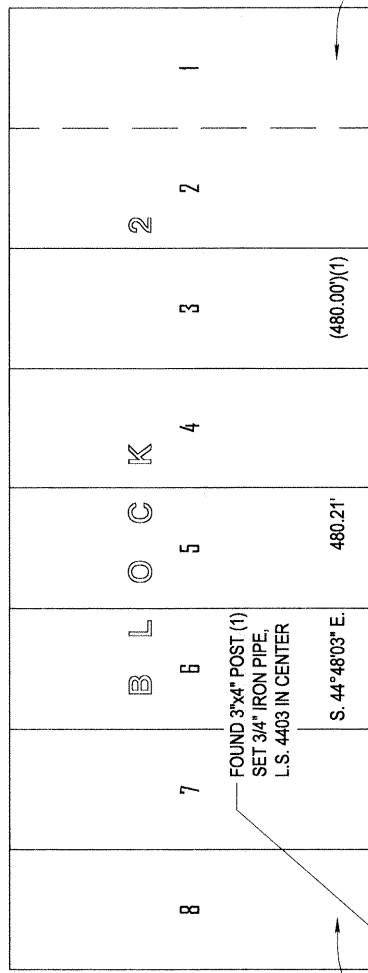

FOUND 1/2" ROD (2)(3)

BASIS OF BEARINGS

N. 45°10'00" E. for the centerline of Jackson Street as shown on the Map of "Hunt's Addition to the Town of LeGrand", Volume 5, Official Plats, Page 10, Merced County Records.

REFERENCES

- (1) Hunt's Addition to the Town of LeGrand, 5 O.P. 10, M.C.R.
- (2) American Heritage Homes #1, 34 O.P. 30, M.C.R.
- (3) F.A.S. 1384(1) - Santa Fe Avenue Survey Map, 7 R.S. 20, M.C.R.

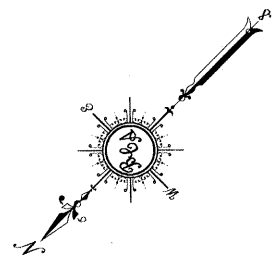

LEGEND

- Found and accepted monument as indicated
- Set 3/4" iron pipe, L.S. 4403