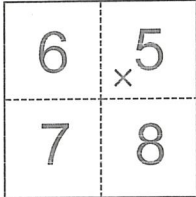

CORNER RECORD

Agency Index 1251

Document Number _____

City of _____ Unincorporated _____ County of _____ Merced _____, California

Brief Legal Description Corner Common to Sections 5,6,7,and 8; T9S; R9E; MD Base and Meridian**CORNER TYPE****COORDINATES (Optional)**

- Government Corner Control
 Meander Property
 Rancho Other

N. _____ E. _____

Elevation _____

Units Metric U.S. Survey Foot

Horizontal Datum _____

Zone _____ Epoch Date _____

Date of Survey September 30, 2018

Vertical Datum _____

 Complies with Public Resources Code §§8801-8819 Complies with Public Resources Code §§8890-8902PLS Act Ref.: 8765(d) 8771 8773 Other:

Corner/Monument: Left as found Established Rebuilt Pre-Construction
 Found and tagged Reestablished Referenced Post-Construction

Narrative of corner identified and monument as found, set, reset, replaced, or removed:

 See sheet #2 for description(s):

Found 1.75" O.D. Iron Pipe (No Tag) at the Intersection of (SR-33) and Bunker Road down 1.25' in a monument well. Per County Recorder Corner Record Document 1251 (2) and 1251 (3).

SURVEYOR'S STATEMENT

This Corner Record was prepared by me or under my direction in conformance with

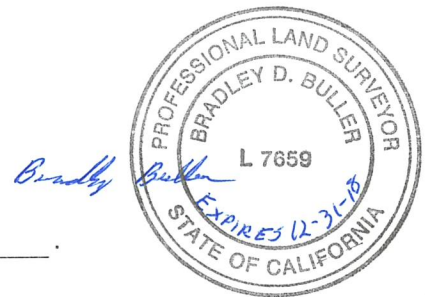
the Professional Land Surveyors' Act on September 30, 2018Signed Bradley D. Buller P.L.S. or R.C.E. No. L7659**COUNTY SURVEYOR'S STATEMENT**This Corner Record was received NOVEMBER 30, 2018and examined and filed DECEMBER 28, 2018Signed Zachary T. Janz P.L.S. or R.C.E. No. 8664Title COUNTY SURVEYOR**County Surveyor's Comment**

CORNER RECORD 1251 (2) AND 1251 (3) FOUND A COTTON SPINDLE. COTTON SPINDLE WAS SET OVER A 1 1/2" O.D. IRON PIPE PER 78 P.M. 19

1251

