

# CORNER RECORD

Document Number \_\_\_\_\_

City of \_\_\_\_\_

County of MERCED, California

Brief Legal Description N.E. COR. SECT. 6 T. 9S. R. 9E. M.D.B. & M.

31	32
6	5

T8S  
R9E

T9S  
R9E

### CORNER TYPE

Government Corner  Control   
 Meander  Property   
 Rancho  Other   
 Date of Survey 1-4-90

### COORDINATES (Optional)

N. \_\_\_\_\_  
 E. \_\_\_\_\_  
 Zone \_\_\_\_\_ Datum \_\_\_\_\_  
 Elev. \_\_\_\_\_

Corner — Left as found  Found and tagged  Established  Reestablished  Rebuilt

Identification and type of corner found: Evidence used to identify or procedure used to establish or reestablish the corner: FOUND 3/4" IRON PIPE WITH PLASTIC PLUG, LS 3664 AT SURFACE, IN CENTER OF INTERSECTION.

A description of the physical condition of the monument as found and as set or reset: MONUMENT APPEARS IN GOOD CONDITION

### SURVEYOR'S STATEMENT

This Corner Record was prepared by me or under my direction in conformance with the Land Surveyors' Act on JAN 4 19 90.

Signed Roy L. Turney L.S. or R.C.E. Number LS 3730

### COUNTY SURVEYOR'S STATEMENT

This Corner Record was received 1-24 19 90 and examined and filed 1-25- 19 90.

Signed Roy L. Turney Title Dep Co. Surveyor COR. # 1250

County Surveyor's Comment \_\_\_\_\_

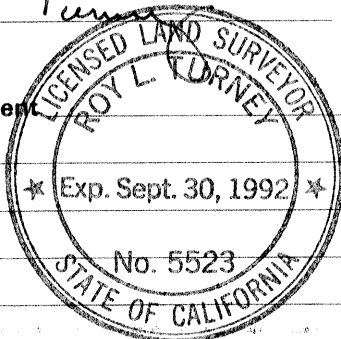

# 1250

31	32	T85R9E
-----		MOBEM
6	5	T95R9E

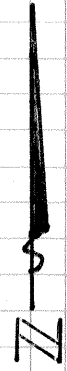

JENSEN RD

USCEGS X 1133  
1961

PK&SHINER  
IN J POLE

COTTONWOOD  
ROAD

PK&SHINER  
IN J POLE

ST. RT. 33

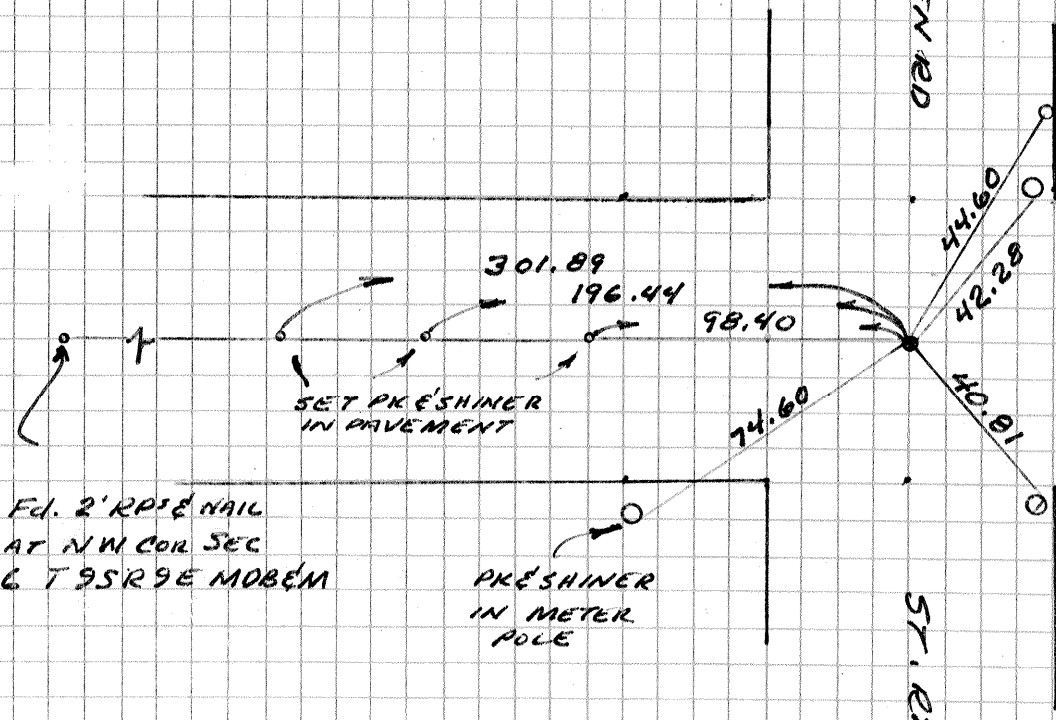

Ed. 2' RP&E NAIL  
AT NW COR SEC  
6 T95R9E MOBEM

PK&SHINER  
IN METER  
POLE

LS3664

3/4" I. PIPE w/ PLASTIC  
AT SURFACE