

1074

CORNER RECORD

COUNTY OF MERCED T. 5S R. 15E M.D. Base & MERIDIAN CALIFORNIA
 CORNER TYPE: GOV'T. CORNER MEANDER RANCHO CONTROL OTHER
 CORNER IDENTIFICATION — DATE OF VISIT Jan. 27 19 75

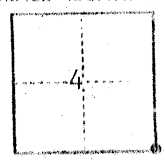

COR. 1074
 S.E. Cor. Sec. 4

CORNER — LEFT AS FOUND FOUND AND TAGGED REESTABLISHED OBLITERATED CORNER REBUILT

PHYSICAL DESCRIPTION OF CORNER FOUND; EVIDENCE AND METHOD USED TO IDENTIFY OR REESTABLISH

Fd. 1 1/2" Iron Pipe set in fence line North & South - no tag

PHYSICAL DESCRIPTION OF MONUMENTS REBUILT OR PERPETUATED

Left as found

CALIFORNIA COORDINATE SYSTEM ORDER: FIRST SECOND THIRD
 STATIONS USED: NGS (USC & GS) STATE COUNTY OTHER STATION _____
 ZONE _____ ELEVATION _____ NORTHINGS (Y) _____ EASTINGS (X) _____

SKETCH: (include reference tie or witness points, remarks and topo of area)

PACIFIC GAS AND ELECTRIC CO.
 LAND DEPT. JOB 183793

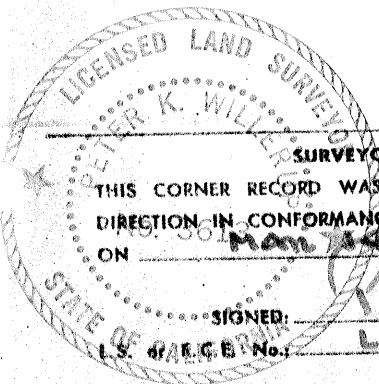
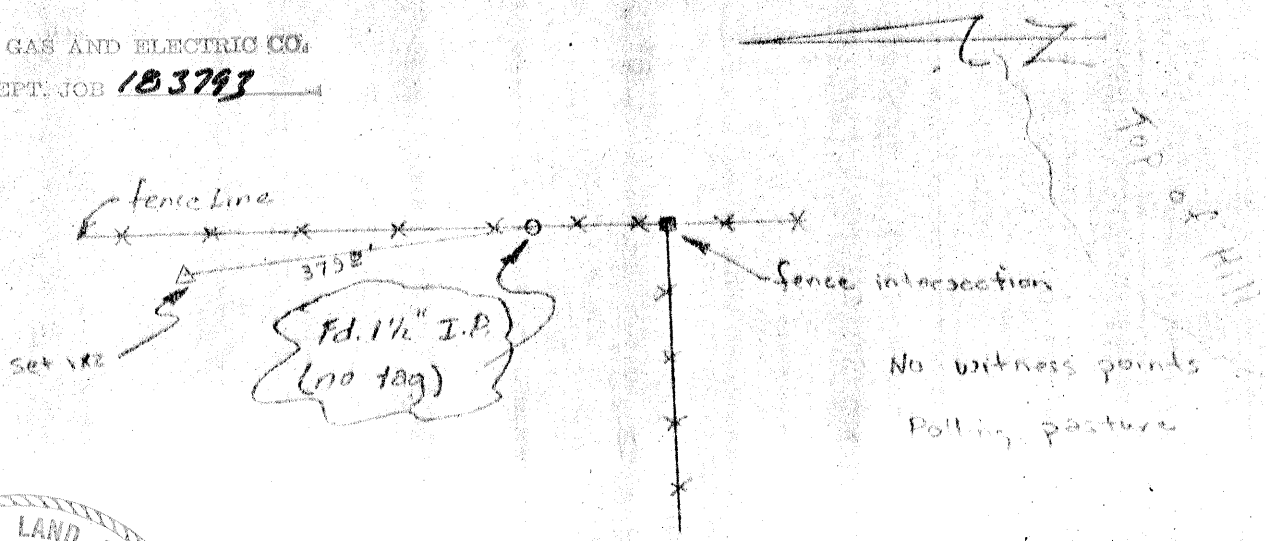

SURVEYOR'S CERTIFICATE
 THIS CORNER RECORD WAS PREPARED BY ME OR UNDER MY DIRECTION IN CONFORMANCE WITH THE LAND SURVEYORS ACT ON Jan 29 19 75
 SIGNED: *[Signature]*
 L.S. & R.C.E. No. LS 2613

COUNTY SURVEYOR'S CERTIFICATE
 THE CORNER RECORD WAS RECEIVED _____ 19 _____
 AND EXAMINED AND FILED _____ 19 _____
 BY: _____
 TITLE: _____
 DOCUMENT No. 1074
 STATEMENT ON BACK OF SHEET YES NO