

CORNER RECORD

Document Number 890-C

City of _____ County of MERCED, California

Brief Legal Description ATWATER DRAIN - PER 5 R.S. 34 IN PARCEL 2 19 P.M. 38.

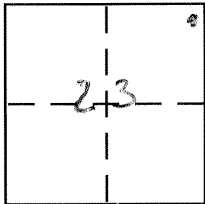

CORNER TYPE

Government Corner Control
Meander Property
Rancho Other
Date of Survey 3-7-07

COORDINATES (Optional)

N. _____
E. _____
Zone _____ NAD27 NAD83
NAD83 Epoch _____
Elev. _____
Vert. Datum: NGVD29 NAVD88
Meas. Units: Metric Imperial

Corner - Left as found Found and tagged Established Reestablished Rebuilt

Identification and type of corner found: Evidence used to identify or procedure used to establish or reestablish the corner:

SEE SKETCH

A description of the physical condition of the monument as found and as set or reset:

SEE SKETCH

SURVEYOR'S STATEMENT

This Corner Record was prepared by me or under my direction in conformance with the Land Surveyor's Act on 4-27-07

Signed [Signature] P.L.S or R.C.E. No. _____

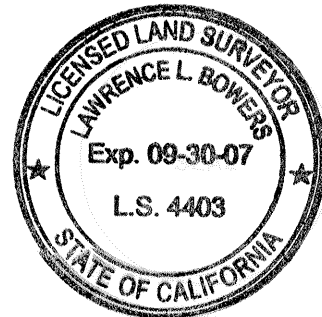

COUNTY SURVEYOR'S STATEMENT

This Corner Record was received April 30, 2007

and examined and filed April 30, 2007

Signed [Signature] P.L.S or ~~R.C.E.~~ No. 4895

Title Dep. County Surveyor

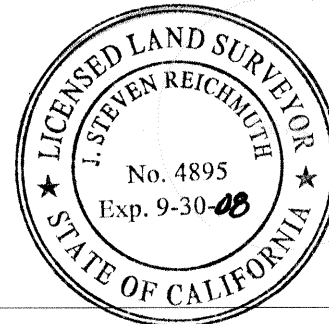

County Surveyor's Comment _____

