

CORNER RECORD

Document Number **881**

City of _____

County of **MERCED**, California

Brief Legal Description **EAST 1/4 CORNER SECTION 18, T. 9S, R. 9E, M.D. BASE 3 MERIDIAN**

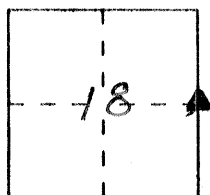

CORNER TYPE

Government Corner Control
 Meander Property
 Rancho Other
 Date of Survey **AUGUST 1, 2000**

COORDINATES (Optional)

N. _____
 E. _____
 Zone _____ Datum _____
 Elev. _____

Corner — Left as found Found and tagged Established Reestablished Rebuilt

Identification and type of corner found: Evidence used to identify or procedure used to establish or reestablish the corner: **FOUND 0.013 M I.P. WITH PLASTIC PLUG STAMPED LS #3664, DOWN 0.050 M BELOW SURFACE. MONUMENT IS LOCATED IN INTERSECTION OF STATE HIGHWAY 33 & HULEN ROAD.**

A description of the physical condition of the monument as found and as set or reset: **MONUMENT WAS RECOVERED IN GOOD CONDITION**

SURVEYOR'S STATEMENT

This Corner Record was prepared by me or under my direction in conformance with the Land Surveyors' Act on **AUGUST 2, 2000**

Signed Andrew B. Sten L.S. or R.C.E. Number **7293**
 Expires **12-31-2000**



COUNTY SURVEYOR'S STATEMENT

This Corner Record was received **SEPT** **2000** and examined and filed **SEPT. 21, 2000.**

Signed Roy L. Turney Title **DEP. CO. SUR.**

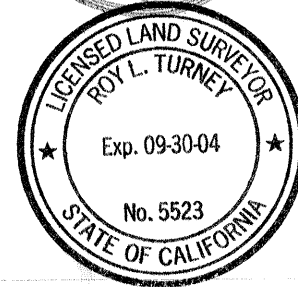

County Surveyor's Comment _____

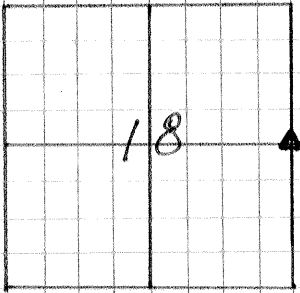

NOT TO SCALE

33

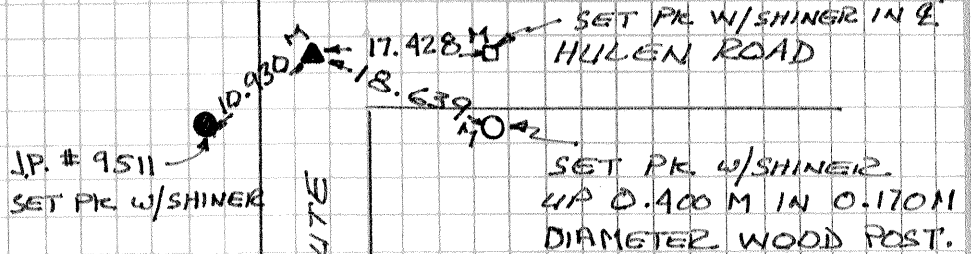

▲ = FOUND 0.013 M DIA. I.P.
 WITH PLASTIC PLUG
 STAMPED LS # 3664
 SET DWN 0.050 M

NOTE

ALL DISTANCES & DIMENSIONS
 ARE METRIC.