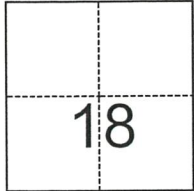

CORNER RECORD

Agency Index 881

Document Number _____

City of _____ Unincorporated _____ County of _____ Merced _____, California

Brief Legal Description East 1/4 Corner Section 18; T9S; R9E; Mount Diablo Base and Meridian**CORNER TYPE****COORDINATES (Optional)**

- Government Corner Control
 Meander Property
 Rancho Other

Date of Survey October 1, 2018

N. _____ E. _____

Elevation _____

Units Metric U.S. Survey Foot

Horizontal Datum _____

Zone _____ Epoch Date _____

Vertical Datum _____

 Complies with Public Resources Code §§8801-8819 Complies with Public Resources Code §§8890-8902PLS Act Ref.: 8765(d) 8771 8773 Other:Corner/Monument: Left as found Established Rebuilt Pre-Construction Found and tagged Reestablished Referenced Post-Construction

Narrative of corner identified and monument as found, set, reset, replaced, or removed:

 See sheet #2 for description(s):

Found 1/2" Iron Pipe with Orange Plastic Plug Stamped "LS 3664" down 0.45' in a monument well in the Intersection of (SR-33) and Hulen Road. Per County Recorder Corner Record, Document 881.

SURVEYOR'S STATEMENT

This Corner Record was prepared by me or under my direction in conformance with

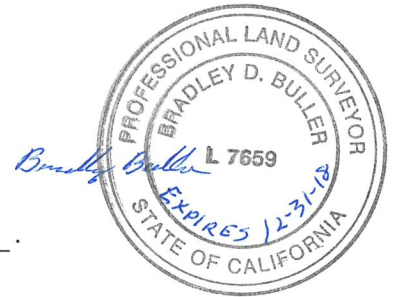
the Professional Land Surveyors' Act on October 30, 2018Signed Bradley D. Buller P.L.S. or R.C.E. No. L 7659**COUNTY SURVEYOR'S STATEMENT**This Corner Record was received NOVEMBER 30, 2018and examined and filed DECEMBER 28, 2018Signed Zachary T. Janz P.L.S. or R.C.E. No. 8664Title COUNTY SURVEYOR

County Surveyor's Comment _____



