

CORNER RECORD

Document Number 820-A(2)

City of \_\_\_\_\_

County of MERCED, California

Brief Legal Description NAIL AT THE CENTERLINE INTERSECTION OF TURNER AND KELLY ROAD

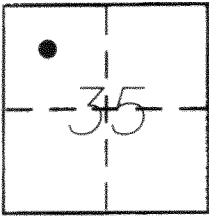

T6S, R9E

CORNER TYPE

Government Corner  Control   
Meander  Property   
Rancho  Other   
Date of Survey 11-7-2014

COORDINATES (Optional)

N. \_\_\_\_\_  
E. \_\_\_\_\_  
Zone \_\_\_\_\_ NAD27  NAD83   
NAD83 Epoch \_\_\_\_\_  
Elev. \_\_\_\_\_  
Vert. Datum: NGVD29  NAVD88   
Meas. Units: Metric  Imperial

Corner - Left as found  Found and tagged  Established  Reestablished  Rebuilt

Identification and type of corner found: Evidence used to identify or procedure used to establish or reestablish the corner:  
FOUND TIES AS SHOWN ON REVERSE SIDE.

MONUMENT WAS DESTROYED WITH CONSTRUCTION PROJECT.

A description of the physical condition of the monument as found and as set or reset: \_\_\_\_\_  
RESET A 3/4" IRON PIPE WITH L.S. 7621 TAG, IN MONUMENT WELL PER CORNER RECORD NO.

SURVEYOR'S STATEMENT

This Corner Record was prepared by me or under my direction in conformance with the Land Surveyor's Act on NOVEMBER 7, 2014  
Signed [Signature] P.L.S or R.G.E. No. 7621



COUNTY SURVEYOR'S STATEMENT

This Corner Record was received November 7, 2014  
and examined and filed November 20, 2014  
Signed [Signature] P.L.S or R.G.E. No. 4895  
Title County Surveyor

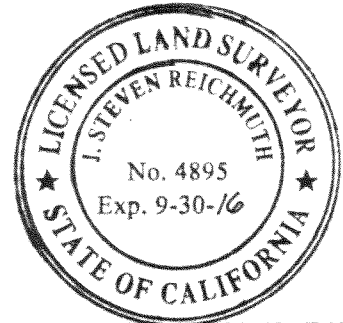

County Surveyor's Comment \_\_\_\_\_

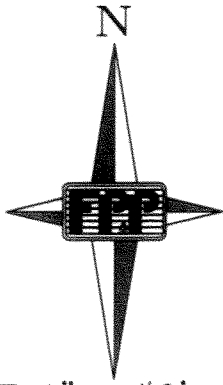

SCALE 1" = 40'

