

CORNER RECORD

Document Number 726-TT
County of MERCED, California

City of DELHI

Brief Legal Description W. COR. PARCEL 'A', BOOK 16, PARCEL MAPS, PAGE 6, M.C.R.

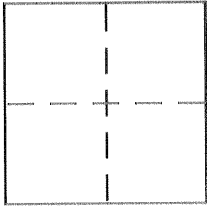

CORNER TYPE

Government Corner Control
Meander Property
Rancho Other
Date of Survey 11/1/01

COORDINATES (Optional)

N. _____
E. _____
Zone _____ NAD27 NAD83
NAD83 Epoch _____
Elev. _____
Vert. Datum: NGVD29 NAVD88
Meas. Units: Metric Imperial

Corner -- Left as found Found and tagged Established Reestablished Rebuilt

Identification and type of corner found: Evidence used to identify or procedure used to establish or reestablish the corner:

SEE OTHER SIDE

A description of the physical condition of the monument as found and as set or reset:

SEE OTHER SIDE

SURVEYOR'S STATEMENT

This Corner Record was prepared by me or under my direction in conformance with

the Land Surveyor's Act on JUNE 15 2002

Signed R. K. Grant P.L.S. or R.C.E. No. 6944

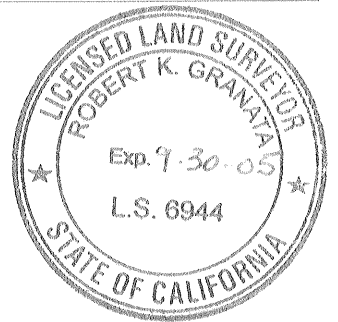

COUNTY SURVEYOR'S STATEMENT

This Corner Record was received JULY 15 2002

and examined and filed AUG. 6 2002

Signed Roy Turney P.L.S. or R.C.E. No. 5523

Title Dep. Co. Surveyor

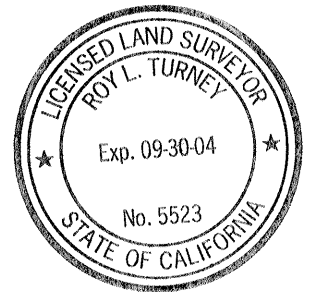

County Surveyor's Comment _____

HINTON STREET

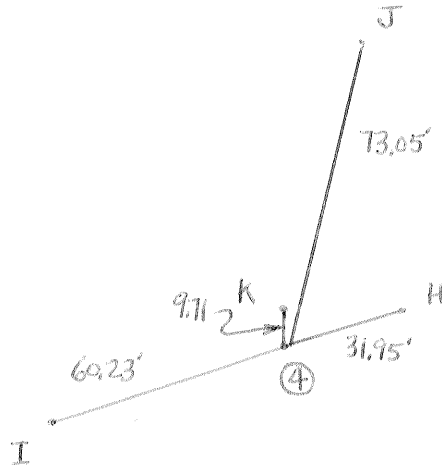
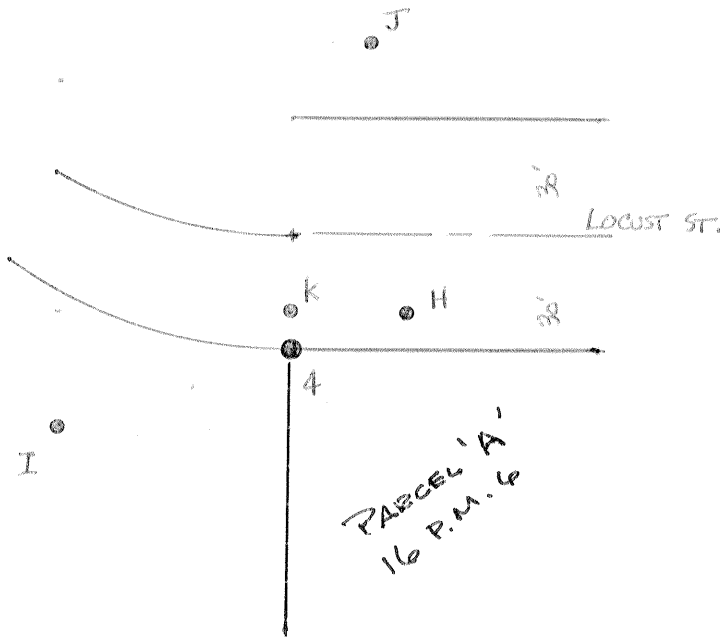

4 - FD. 1" I.P., RCE 6888, DOWN 0^o; 10' SE OF FACE OF CURB, 6' NE OF NE EP. OF AC LOT FOR "DELHI UNIFIED SCHOOL DISTRICT" OFFICE

H - SET CHIS. "1" ON T.C.; OPP. E of 6' CONC. WALK SE TO BLDG. # 16091

I - SET MAG NAIL IN A.C.; 5' NW OF NW EDGE OF BOTTOM STEP, OPP. E of FRONT DOOR TO "DELHI UNIFIED SCHOOL DISTRICT" OFFICE

J - SET CHIS. "1" ON TOP OF SE EDGE OF 15" DIA. x 3' TALL CONC. BASE FOR PARKING LOT LIGHT AT SE SIDE OF PARKING LOT AT SW SIDE OF POST OFFICE

K - SET PUNCH HOLE IN E of FD, CHIS. "1" ON T.C.; 10' ± NW of Pt. # 4