

# CORNER RECORD

Document Number 724 AAA  
County of MERCED, California

City of MERCED  
Brief Legal Description \_\_\_\_\_

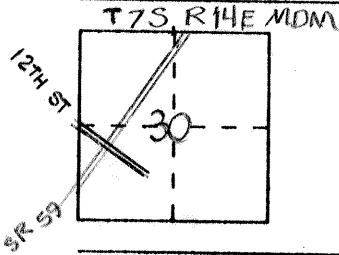

### CORNER TYPE

Government Corner  Control   
 Meander  Property   
 Rancho  Other   
 Date of Survey 1/05/99

### COORDINATES (Optional)

N. \_\_\_\_\_  
 E. \_\_\_\_\_  
 Zone \_\_\_\_\_ Datum \_\_\_\_\_  
 Elev. \_\_\_\_\_

Corner — Left as found  Found and tagged  Established  Reestablished  Rebuilt

Identification and type of corner found: Evidence used to identify or procedure used to establish or reestablish the corner: NO TAG, NO REFERENCE

A description of the physical condition of the monument as found and as set or reset: \_\_\_\_\_

FOUND GIN SPIKE MARKED "SURVEY MARKER" (FLUSH IN CRACK IN CONCRETE SIDEWALK)  
IN GOOD CONDITION

### SURVEYOR'S STATEMENT

This Corner Record was prepared by me or under my direction in conformance with the Land Surveyors' Act on JANUARY 5 1999.

Signed Robin L. Wickline L.S. or R.C.E. Number 7026  
 Expires 6/30/02



### COUNTY SURVEYOR'S STATEMENT

This Corner Record was received FEB 5 1999 and examined and filed FEB 23 1999.

Signed Roy L. Turney Title DEP CO. SUR.

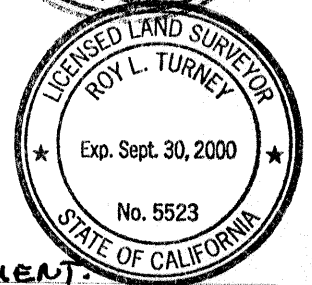

County Surveyor's Comment NO RECORD HISTORY OF MONUMENT.

SR 981439

MARTIN LUTHER KING STREET STATE ROUTE 59  
(17' STREET) (80' R/W) A/C PAVEMENT

CONC. S/W

SCALE: 1:250

ROUND 6IN SPIKE  
MARKED "SURVEY  
MARKER"  
(FLUSH IN CONC. S/W)  
NO TAG NO REF

12TH STREET  
(80' R/W)  
A/C PAVEMENT

LEGEND:

- DENOTES FOUND MONUMENT AS NOTED
- DENOTES SET PK WITH TIN AS REFERENCE  
UNLESS OTHERWISE NOTED
- m DENOTES DISTANCE MEASURED IN METERS