

#6.)

CORNER RECORD

COUNTY OF MERCED T. 9 S. R. 13 E. M.D. MERIDIAN CALIFORNIA

CORNER TYPE: GOV'T. CORNER MEANDER RANCHO CONTROL OTHER
CORNER IDENTIFICATION — DATE OF VISIT Oct 19 1979

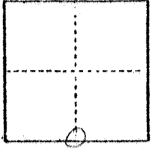

South 1/4 corner of section 14

CORNER — LEFT AS FOUND FOUND AND TAGGED REESTABLISHED OBLITERATED CORNER REBUILT

PHYSICAL DESCRIPTION OF CORNER FOUND; EVIDENCE AND METHOD USED TO IDENTIFY OR REESTABLISH
Found a 3 1/2" x 4" redwood post. Prolonged the north-south 1/2 section line from the interior 1/4 corner. Measured south, on line, from the interior corner 2644.22 to find the south 1/4 corner.

PHYSICAL DESCRIPTION OF MONUMENTS REBUILT OR PERPETUATED
Placed 1 3/8" outside diameter iron pipe by 30" long through center of post. Tagged "Merced County Surveyor"

CALIFORNIA COORDINATE SYSTEM ORDER: FIRST SECOND THIRD
STATIONS USED: NGS (USC & GS) STATE COUNTY OTHER STATION _____ STATION _____
ZONE _____ ELEVATION _____ NORTHINGS (Y) _____ EASTINGS (X) _____

(Fold)

SKETCH: (Include reference tie or witness points, remarks and topo of area)

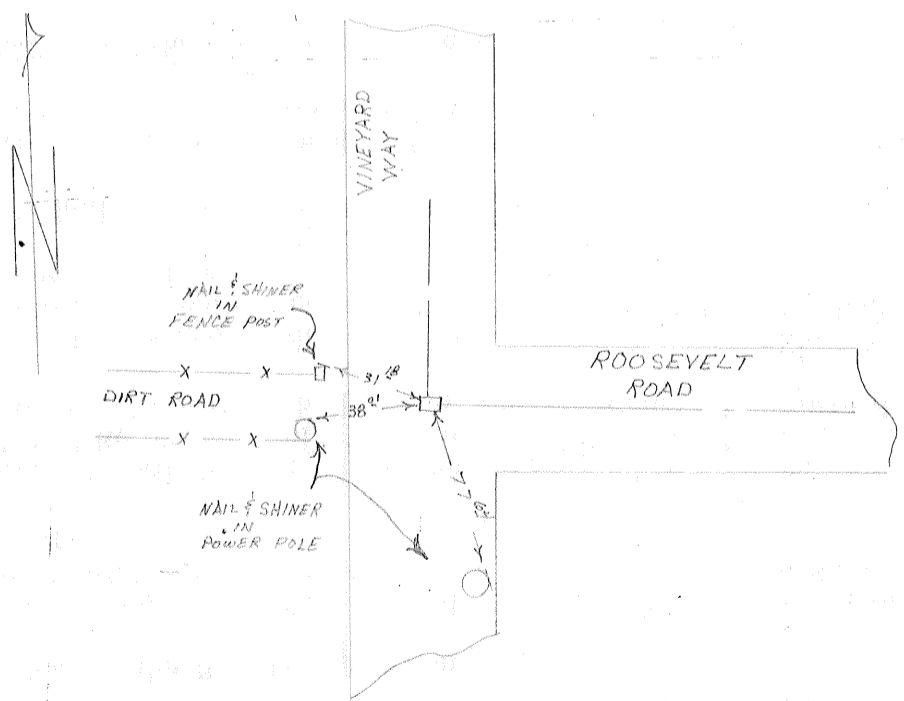

SURVEYOR'S CERTIFICATE
THIS CORNER RECORD WAS PREPARED BY ME OR UNDER MY DIRECTION IN CONFORMANCE WITH THE LAND SURVEYORS ACT
Gr. _____ 19_____
SIGNED: _____
L.S. or R.C.E. No.: _____

SEAL

COUNTY SURVEYOR'S CERTIFICATE
THE CORNER RECORD WAS RECEIVED _____ 19_____
AND EXAMINED AND FILED _____ 19_____
BY: _____
TITLE: _____
DOCUMENT No. 690
STATEMENT ON BACK OF SHEET YES NO