

# CORNER RECORD

Document Number 663-A

City of \_\_\_\_\_ County of MERCED, California

Brief Legal Description Lot 484 80.P. 16

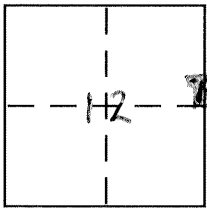

### CORNER TYPE

Government Corner  Control   
 Meander  Property   
 Rancho  Other   
 Date of Survey 9-28-06

### COORDINATES (Optional)

N. \_\_\_\_\_  
 E. \_\_\_\_\_  
 Zone \_\_\_\_\_ NAD27  NAD83   
 NAD83 Epoch \_\_\_\_\_  
 Elev. \_\_\_\_\_  
 Vert. Datum: NGVD29  NAVD88   
 Meas. Units: Metric  Imperial

Corner - Left as found  Found and tagged  Established  Reestablished  Rebuilt

Identification and type of corner found: Evidence used to identify or procedure used to establish or reestablish the corner:

SEE SKETCH

A description of the physical condition of the monument as found and as set or reset:

SEE SKETCH

### SURVEYOR'S STATEMENT

This Corner Record was prepared by me or under my direction in conformance with the Land Surveyor's Act on 11-17-06

Signed [Signature] P.L.S or R.C.E. No. \_\_\_\_\_

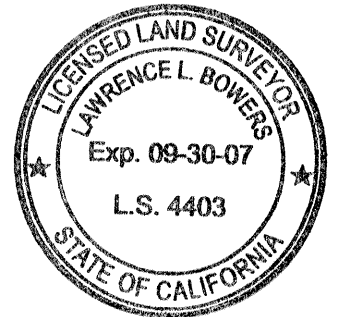

### COUNTY SURVEYOR'S STATEMENT

This Corner Record was received Nov. 17, 2006

and examined and filed November 22, 2006

Signed [Signature] P.L.S or ~~P.C.E.~~ No. 4895

Title Dep. County Surveyor

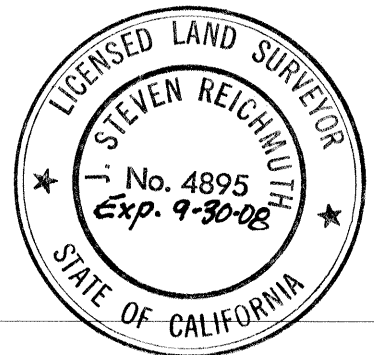

County Surveyor's Comment \_\_\_\_\_

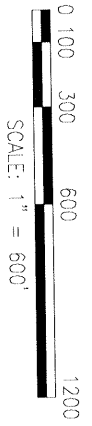
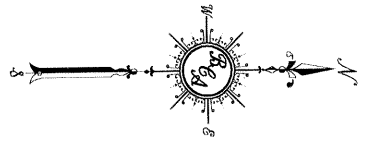

**BASIS OF BEARINGS**  
 N. 89°48'00" E. for the north line of Lots 480-483 as shown on the Map of Ballico Unit of the Delhi Land Settlement, Volume 8, Official Plats, Page 16, Merced County Records.

- REFERENCES**
- (1) Ballico Unit of the Delhi Land Settlement, 8 O.P. 16, M.C.R.
  - (2) Parcel Map for Harry Nishihara, 103, P.M. 10, M.C.R.
  - (3) Parcel Map for Alfred Sammann, 73 P.M. 10, M.C.R.

- LEGEND**
- Found and accepted monument as indicated
  - Set 3/4" iron pipe, L.S. 4403
  - C.R. Calculated from Record

- ① EAST QUARTER CORNER SECTION 12, FOUND 3/4" IRON PIPE, L.S. 4403 (2)
- ② FOUND 8"Ø CONCRETE MONUMENT (1)(2)

