

CORNER RECORD

COUNTY OF MERCED T. 11S. R. 13E. M.D.B. & MERIDIAN CALIFORNIA

CORNER TYPE: GOV'T. CORNER MEANDER RANCHO CONTROL OTHER

CORNER IDENTIFICATION — DATE OF VISIT APRIL 8, 1986

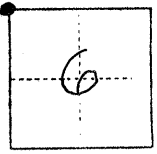

NORTHWEST CORNER SECTION 6 11/13

INDIANA & EUCALYPTUS AVE'S.

CORNER — LEFT AS FOUND FOUND AND TAGGED REESTABLISHED OBLITERATED CORNER REBUILT

PHYSICAL DESCRIPTION OF CORNER FOUND; EVIDENCE AND METHOD USED TO IDENTIFY OR REESTABLISH

FOUND 5/8" IRON ROD - BENT - 3" DOWN IN MERCED CO.
HANDWELL - COVER GONE - W/ 2' TIES S. & W.

PHYSICAL DESCRIPTION OF MONUMENTS REBUILT OR PERPETUATED

STRAIGHTENED ROD FROM 2' TIES & SET PLASTIC
CAP "W.O. GENTRY - L.S. 2737"

CALIFORNIA COORDINATE SYSTEM ORDER: FIRST SECOND THIRD
STATIONS USED: NGS (USC & GS) STATE COUNTY OTHER STATION _____ STATION _____
ZONE _____ ELEVATION _____ NORTHINGS (Y) _____ EASTINGS (X) _____

SKETCH: (Include reference tie or witness points, remarks and topo of area)

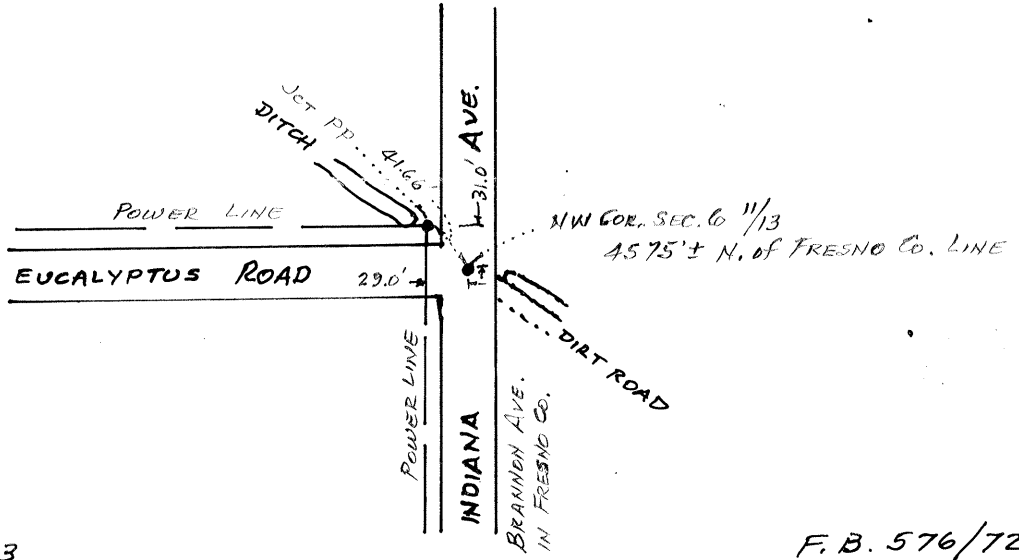

J.N. 86-013

F.B. 576/72

SURVEYOR'S CERTIFICATE

THIS CORNER RECORD WAS PREPARED BY ME OR UNDER MY DIRECTION IN CONFORMANCE WITH THE LAND SURVEYORS ACT ON APRIL 9, 1986

SIGNED: William O. Gentry
L.S. or R.C.E. No.: 2737

COUNTY SURVEYOR'S CERTIFICATE

THE CORNER RECORD WAS RECEIVED 4-15-1986 AND EXAMINED AND FILED 4-15-1986

BY: Ray Tammey
TITLE: Deputy Co. Surveyor

DOCUMENT No. 586

STATEMENT ON BACK OF SHEET