

CORNER RECORD

Document Number 585

City of _____

County of MERCED, California

Brief Legal Description N.W. CORNER SECTION 31, T. 10S, R. 13E., M.D.B. & M.

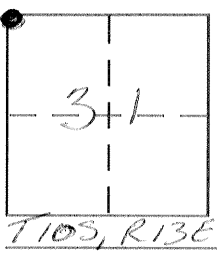

CORNER TYPE

Government Corner Control
 Meander Property
 Rancho Other
 Date of Survey 6-7-02

COORDINATES (Optional)

N. _____
 E. _____
 Zone _____ NAD27 NAD83
 NAD83 Epoch _____
 Elev. _____
 Vert. Datum: NGVD29 NAVD88
 Meas. Units: Metric Imperial

Corner - Left as found Found and tagged Established Reestablished Rebuilt

Identification and type of corner found: Evidence used to identify or procedure used to establish or reestablish the corner:

N.W. CORNER SECTION 31, TOWNSHIP 10 SOUTH, RANGE 13 EAST, M.D.B. & M., AS SHOWN ON §1 PM 36, M.C.R., 26 RS 5, M.C.R., 36 P.M. 25, M.C.R. COUNTY FIELD BOOK 710 pg. 38

A description of the physical condition of the monument as found and as set or reset: FOUND 5/8" IRON BAR

IN MONUMENT WELL. WILL BE DESTROYED BY ROAD CONSTRUCTION

SURVEYOR'S STATEMENT

This Corner Record was prepared by me or under my direction in conformance with

the Land Surveyor's Act on JUNE 12, 2002

Signed David D. Heinrichs P.L.S or R.C.E. No. 7621



COUNTY SURVEYOR'S STATEMENT

This Corner Record was received 7-8-02

and examined and filed 8-8-02

Signed Roy L. Turney P.L.S or R.C.E. No. 5523

Title Dep. Co. Surveyor

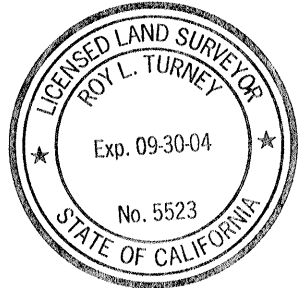

County Surveyor's Comment _____

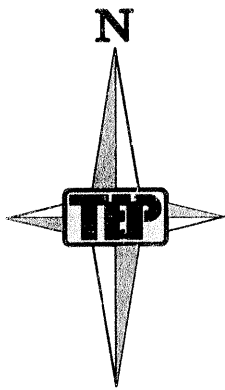

SCALE 1" = 20'

