

CR# 26

CORNER RECORD

COUNTY OF MERCED T. 5S. R. 12E. M.D.B. & MERIDIAN CALIFORNIA
 CORNER TYPE: GOVT. CORNER MEANDER RANCHO CONTROL OTHER
 CORNER IDENTIFICATION - DATE OF VISIT JULY 9, 1991



NORTH 1/4 CORNER SECTION 14 5/12

CORNER - LEFT AS FOUND FOUND AND TAGGED REESTABLISHED OBLITERATED CORNER REBUILT

PHYSICAL DESCRIPTION OF CORNER FOUND, EVIDENCE AND METHOD USED TO IDENTIFY OR REESTABLISH
FOUND 1/2" IRON PIPE - L.S. 4379 - DOWN 6"

PHYSICAL DESCRIPTION OF MONUMENTS REBUILT OR PERPETUATED

CALIFORNIA COORDINATE SYSTEM ORDER: FIRST SECOND THIRD
 STATIONS USED: NGS (USC & GS) STATE COUNTY OTHER STATION _____ STATION _____
 ZONE _____ ELEVATION _____ NORTHINGS (N) _____ EASTINGS (E) _____

SKETCH: (Include reference tie or witness points, remarks and topo of area)

22.37' NW OF @ SW/5 RR TIE GATE POST.
 18.42' NE OF @ SE/5 RR TIE GATE POST.
 16.70' N. OF ALMOND ROWS E. & W.
 19.00' W. OF ALMOND ROW N.
 20.00' W. OF ALMOND ROW S.
 12.60' E. OF ALMOND ROWS N. & S.
 11.50' S. OF ALMOND ROW E.
 32.70' S. OF ALMOND ROW W.

See P.M. Bk. 60 P9, 3

J.N. 91-041

F.B. 587/4

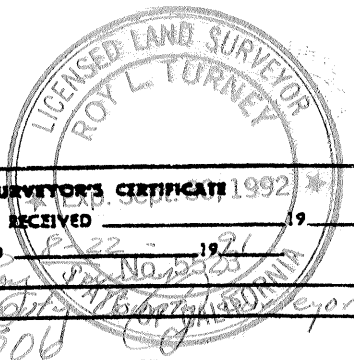

SURVEYOR'S CERTIFICATE
 THIS CORNER RECORD WAS PREPARED BY ME OR UNDER MY DIRECTION IN CONFORMANCE WITH THE LAND SURVEYORS ACT ON JULY 9, 1991
 SIGNED: William O. Gentry
 L.S. or R.C.E. No. 2737
 EXPIRES: 6-30-1992

COUNTY SURVEYOR'S CERTIFICATE 1992
 THE CORNER RECORD WAS RECEIVED _____ 19____ AND EXAMINED AND FILED _____ 19____
 BY: Raymond No. 5520
 TITLE: Debit 1/16/91
 DOCUMENT No. # 506
 STATEMENT ON BACK OF SHEET YES NO

SEAL