

#499

CORNER RECORD

COUNTY OF MERCED T. 5S. R. 12E M.D. MERIDIAN CALIFORNIA

CORNER TYPE: GOV'T. CORNER MEANDER RANCHO CONTROL OTHER

CORNER IDENTIFICATION — DATE OF VISIT October 24 1979

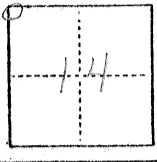

Northwest corner of section 14

CORNER — LEFT AS FOUND FOUND AND TAGGED REESTABLISHED OBLITERATED CORNER REBUILT

PHYSICAL DESCRIPTION OF CORNER FOUND; EVIDENCE AND METHOD USED TO IDENTIFY OR REESTABLISH

Monument found was brass cap with "7" stamped in it. Found November 8, 1976. Found witness posts 19.85 feet west, 20 feet east and 25 feet east. Reestablished by using swing ties in field book 711 page 23.

PHYSICAL DESCRIPTION OF MONUMENTS REBUILT OR PERPETUATED

Brass cap was destroyed during road construction. Replaced with 1/4" outside diameter iron pipe, 30" long. Tagged "Merced County Surveyor"

CALIFORNIA COORDINATE SYSTEM ORDER: FIRST SECOND THIRD
STATIONS USED: NGS (USC & GS) STATE COUNTY OTHER STATION _____ STATION _____
ZONE _____ ELEVATION _____ NORTHINGS (Y) _____ EASTINGS (X) _____

(Fold)

SKETCH: (Include reference tie or witness points, remarks and topo of area)

NOTE: WITNESS MONUMENTS USED TO IDENTIFY SECTION CORNER ARE OBLITERATED.

SECTION CORNER IS 26 FEET SOUTH OF ALMOND ORCHARD TO WEST AND 19 FEET WEST OF POLE LINE TO SOUTH.

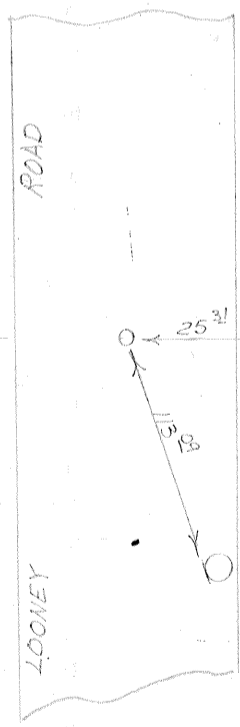

1/4" O.D.I.P. placed 5" IN center of rotted 3"x4" R.W. post tagged "MERCED COUNTY SURVEYOR"

SURVEYOR'S CERTIFICATE

THIS CORNER RECORD WAS PREPARED BY ME OR UNDER MY DIRECTION IN CONFORMANCE WITH THE LAND SURVEYORS ACT OF _____ 19____.

SIGNED: _____
L.S. or R.C.E. No.: _____

SEAL

COUNTY SURVEYOR'S CERTIFICATE

THE CORNER RECORD WAS RECEIVED _____ 19____ AND EXAMINED AND FILED _____ 19____

BY: _____
TITLE: _____

DOCUMENT No. 499

STATEMENT ON BACK OF SHEET YES NO