

CORNER RECORD

COUNTY OF MERCED T. 9 S. R. 15 E. M.D.B. & MERIDIAN CALIFORNIA

CORNER TYPE: GOV'T. CORNER MEANDER RANCHO CONTROL OTHER

CORNER IDENTIFICATION — DATE OF VISIT MAY 20, 1987

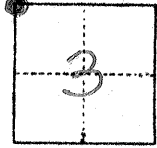

NORTH WEST CORNER SECTION 3 1/15

SANDY MUSH ROAD

CORNER — LEFT AS FOUND FOUND AND TAGGED REESTABLISHED OBLITERATED CORNER REBUILT

PHYSICAL DESCRIPTION OF CORNER FOUND; EVIDENCE AND METHOD USED TO IDENTIFY OR REESTABLISH

FOUND 2" I.P. - 11" DOWN W/ 2' TIES

PHYSICAL DESCRIPTION OF MONUMENTS REBUILT OR PERPETUATED

CALIFORNIA COORDINATE SYSTEM ORDER: FIRST SECOND THIRD
STATIONS USED: NGS (USC & GS) STATE COUNTY OTHER STATION _____ STATION _____
ZONE _____ ELEVATION _____ NORTHINGS (Y) _____ EASTINGS (X) _____

SKETCH: (Include reference tie or witness points, remarks and topo of area)

68.83 SW of O in PP.
21.0' S. of PL E. - OMIT 1st Pole.
2.4' E. v PL S. - OMIT 2nd Pole
0.8' N. v PL 1/4 Mile E.
24.6' S. of PL W.

J.N. 86-030

F.B. 579/3

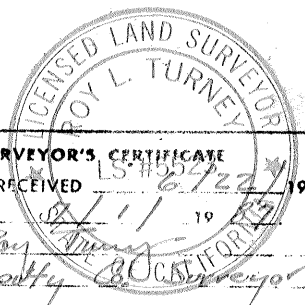

SURVEYOR'S CERTIFICATE

THIS CORNER RECORD WAS PREPARED BY ME OR UNDER MY DIRECTION IN CONFORMANCE WITH THE LAND SURVEYORS ACT ON JUNE 12, 1987

SIGNED: William O. Gentry

L.S. or R.C.E. No.: 2737
EXPIRES 6-30-1988

COUNTY SURVEYOR'S CERTIFICATE

THE CORNER RECORD WAS RECEIVED 6/22/87 1987 AND EXAMINED AND FILED 6/11/87 1987

BY: Roy L. Turney
TITLE: Deputy County Surveyor

DOCUMENT No. 456

STATEMENT ON BACK OF SHEET