

# CORNER RECORD

COUNTY OF Merced T. 8 S. R. 15 E. M.D.B. MERIDIAN CALIFORNIA  
 CORNER TYPE: GOVT. CORNER  MEANDER  RANCHO  CONTROL  OTHER   
 CORNER IDENTIFICATION — DATE OF VISIT May 19 1983

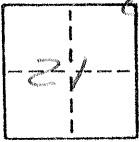

CORNER — LEFT AS FOUND  FOUND AND TAGGED  REESTABLISHED OBLITERATED CORNER  REBUILT

PHYSICAL DESCRIPTION OF CORNER FOUND; EVIDENCE AND METHOD USED TO IDENTIFY OR REESTABLISH  
 Found 1 1/2" inside diameter iron pipe 2 1/2 feet down.  
 Found by using ties in field book "F.A.S. 555(3) Culture"  
 Page 3

PHYSICAL DESCRIPTION OF MONUMENTS REBUILT OR PERPETUATED  
 Set 1" inside diameter iron pipe and tagged "County Surveyor"; over 1 1/2" inside diameter iron pipe; in survey encasement.

CALIFORNIA COORDINATE SYSTEM ORDER: FIRST  SECOND  THIRD   
 STATIONS USED: NGS (USC & GS)  STATE  COUNTY  OTHER  STATION \_\_\_\_\_ STATION \_\_\_\_\_  
 ZONE \_\_\_\_\_ ELEVATION \_\_\_\_\_ NORTHINGS (Y) \_\_\_\_\_ EASTINGS (X) \_\_\_\_\_

SKETCH: (Include reference tie or witness points, remarks and topo of area)

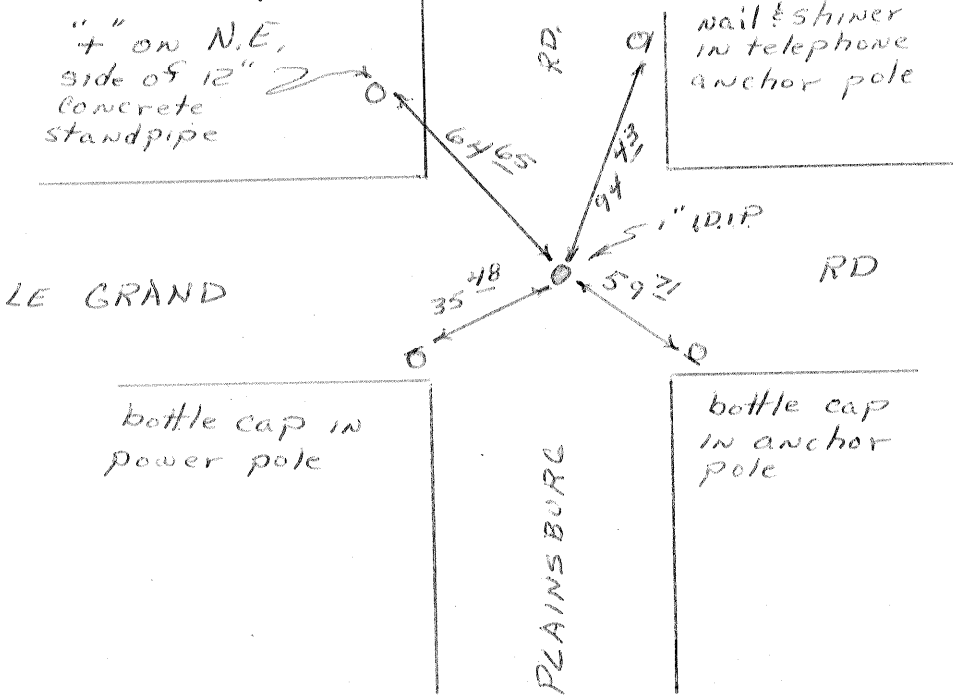

Prepared by  
 Gary Grinder  
 Party Chief  
 Ties in F.B. "F.A.S. 555(3)  
 Alinement, Culture" page 3  
 Gary Grinder

**SURVEYOR'S CERTIFICATE**  
 THIS CORNER RECORD WAS PREPARED BY ME OR UNDER MY DIRECTION IN CONFORMANCE WITH THE LAND SURVEYORS ACT ON \_\_\_\_\_ 19\_\_\_\_\_  
 SIGNED: \_\_\_\_\_  
 L.S. or R.C.E. No.: \_\_\_\_\_  
 SEAL

**COUNTY SURVEYOR'S CERTIFICATE**  
 THE CORNER RECORD WAS RECEIVED \_\_\_\_\_ 19\_\_\_\_\_  
 AND EXAMINED AND FILED \_\_\_\_\_ 19\_\_\_\_\_  
 BY: [Signature]  
 TITLE: County Surveyor  
 DOCUMENT No. 437  
 STATEMENT ON BACK OF SHEET YES  NO