

CONJUNCTION RECORD

COUNTY OF MERCED T. 8 S. R. 15 E. M.D.B. & MERIDIAN CALIFORNIA

CORNER TYPE: GOV'T. CORNER MEANDER RANCHO CONTROL OTHER

CORNER IDENTIFICATION — DATE OF VISIT MAY 19, 19 87

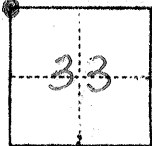

NORTHWEST CORNER SECTION 33 8/15

BUCHANAN HOLLOW ROAD & WHEALON ROAD ALIGNMENT

CORNER — LEFT AS FOUND FOUND AND TAGGED REESTABLISHED OBLITERATED CORNER REBUILT

PHYSICAL DESCRIPTION OF CORNER FOUND; EVIDENCE AND METHOD USED TO IDENTIFY OR REESTABLISH

FOUND 2" I.P. - NO TAG - 20" DOWN

PHYSICAL DESCRIPTION OF MONUMENTS REBUILT OR PERPETUATED

I TAGGED PIPE L.S. 2737 & SET 2' TIES N. & E.

CALIFORNIA COORDINATE SYSTEM ORDER: FIRST SECOND THIRD
STATIONS USED: NGS (USC & GS) STATE COUNTY OTHER STATION _____ STATION _____
ZONE _____ ELEVATION _____ NORTHINGS (Y) _____ EASTINGS (X) _____

SKETCH: (Include reference tie or witness points, remarks and topo of area)

- 0.55' W. of Fence N.
- 28.80' S. of Fence E. & W.
- 25.80' S. of PL E. & W.
- 82.34' SW of @ in SE/S of PP.
- 30.40' S. of Ctr. Cor. Fence Post.

J.N. 86-030

F.B. 579/3

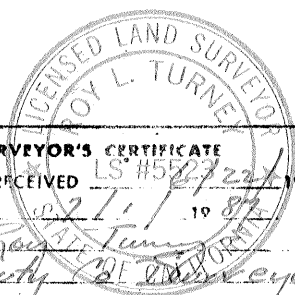

SURVEYOR'S CERTIFICATE

THIS CORNER RECORD WAS PREPARED BY ME OR UNDER MY DIRECTION IN CONFORMANCE WITH THE LAND SURVEYORS ACT ON JUNE 12, 19 87

SIGNED: William O. Gentry
L.S. or R.C.E. No.: 2737

EXPIRES 6-30-1988

COUNTY SURVEYOR'S CERTIFICATE

THE CORNER RECORD WAS RECEIVED LS 115 2722 19 87 AND EXAMINED AND FILED 271 19 87

BY: Roy L. Turner
TITLE: Deputy Surveyor

DOCUMENT No. 434

STATEMENT ON BACK OF SHEET

YES NO