

CORNER RECORD

Document Number 430-R

City of Unincorporated area County of Merced, California

Brief Legal Description Parcel 1 of Parcel Map filed in Book 13 of Parcel Maps at page 24

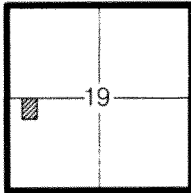

CORNER TYPE

SEC. 19
T6S, R10E
M.D.B. & M.

Government Corner Control
 Meander Property
 Rancho Other

Date of Survey February 7, 2007

COORDINATES (Optional)

N. _____
 E. _____
 Zone _____ NAD27 NAD83
 NAD83 Epoch _____
 Elev. _____
 Vet. Datum: NGVD29 NAVD88
 Meas. Units: Metric Imperial

Corner - Left as found Found and tagged Established Reestablished Rebuilt

Identification and type of corner found: Evidence used to identify or procedure used to establish or reestablish the corner:
Found 2" iron pipe monumentation at intersection of Geer Road with Washington Road
and Geer Road with Faith Home Road per 13 Parcel Maps 24, M.C.R., held.

A description of the physical condition of the monument as found and as set or reset: _____
Set monumentation - 3/4" iron pipe with yellow plastic plug, Tack and tag "LS 7539"

SURVEYOR'S STATEMENT

This Corner Record was prepared by me or under my direction in conformance with
 the Land Surveyor's Act on February 27, 2007

Signed [Signature] P.L.S. or R.C.E. No. LS 7539



COUNTY SURVEYOR'S STATEMENT

This Corner Record was received March 1, 2007

and examined and filed March 15, 2007

Signed [Signature] P.L.S. or R.C.E. No. 4895

Title Dep. County Surveyor

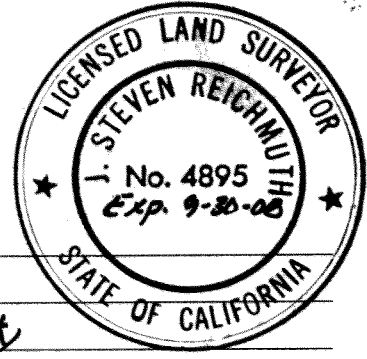

County Surveyor's Comment: This survey does not
appear to accurately depict the Geer
Avenue right of way. See Merced County
Field Book No. 718, Page 23.

(D.D. Sheet No.31A)

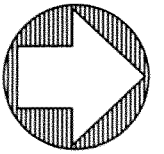

1" = 100'

GEER

AVENUE

- BASIS OF BEARINGS -
N89°53'00"E(1&2) 5206.02' (5205.80')(2)
N89°53'00"E 1244.97' (1244.77')(1)(1244.02)(2)

FD. 2" I.P. & SPINDLE PER(1&2)

FD. 2" I.P. (OPEN) IN MONUMENT WELL PER(1&2)

FOUND 3/4" IRON PIPE TAGGED R.C.E. 12316 (2)

FD NAIL & TAG UNDER PAVEMENT LIFT PER 36 PM 12

205.01' (204.98')(1)

N89°53'00"E 622.45' (622.38')(1)

208.73' (208.70')(1)

S00°05'30"E 20.00'

N00°07'00"W

208.70'(1)

PARCEL 1
13 PM 24
LANDS OF FISHER

S00°07'00"E

208.70'(1)

208.73' (208.70')(R1)

S89°53'00"W

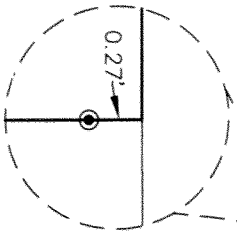

S00°05'30"E

PARCEL 1
28 PM 23

PARCEL 2
28 PM 23

LANDS OF FERREIRA
045-190-009

PARCEL 2
13 PM 24
LANDS OF COTTA

- REFERENCES:**
- (1) 13 PARCEL MAPS 24
 - (2) 28 PARCEL MAPS 23

NOTE:

ALL DISTANCES ARE MEASURED (UNLESS OTHERWISE NOTED) AND ARE IN FEET AND DECIMALS THEREOF.

LEGEND:

- FD FOUND
- I.P. IRON PIPE
- L.S. LICENSED LAND SURVEYOR
- PM PARCEL MAP
- R.C.E. REGISTERED CIVIL ENGINEER
- () INDICATES RECORD DATA
- SET 3/4" I.P. WITH PLUG, TAGGED "LS 7539"
- ◉ FOUND MONUMENT AS NOTED
- ◐ FOUND IRON PIPE AS NOTED
- ◑ FOUND NAIL AND TAG AS NOTED

ROAD

HOME

FAITH

ROAD

WASHINGTON