

CORNER RECORD

Document Number 410

City of MERCED

County of MERCED, California

Brief Legal Description SOUTH WEST CORNER OF SECTION 8, T.7 S., R.14 E. MDB&M.

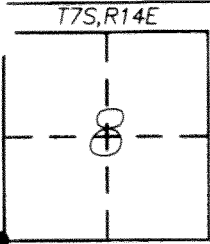

CORNER TYPE

Government Corner Control
 Meander Property
 Rancho Other
 Date of Survey 1-11-2012

COORDINATES (Optional)

N. _____
 E. _____
 Zone NAD27 NAD83
 NAD83 Epoch _____
 Elev. _____
 Vert. Datum: NGVD29 NAVD88
 Meas. Units: Metric Imperial

Corner - Left as found Found and tagged Established Reestablished Rebuilt

Identification and type of corner found: Evidence used to identify or procedure used to establish or reestablish the corner:
FOUND 3" BRASS DISC IN MONUMENT BOX AS SHOWN ON 84 PM 28, M.C.R.
MONUMENT MAY BE DESTROYED WITH CONSTRUCTION PROJECT.

A description of the physical condition of the monument as found and as set or reset: _____

SURVEYOR'S STATEMENT

This Corner Record was prepared by me or under my direction in conformance with the Land Surveyor's Act on JAN 13, 2012

Signed David D. Heinrich P.L.S or R.C.E. No. 7621



COUNTY SURVEYOR'S STATEMENT

This Corner Record was received January 17, 2012
 and examined and filed January 30, 2012

Signed J. Steven Reichmuth P.L.S or R.C.E. No. 4895

Title Deputy County Surveyor

County Surveyor's Comment _____

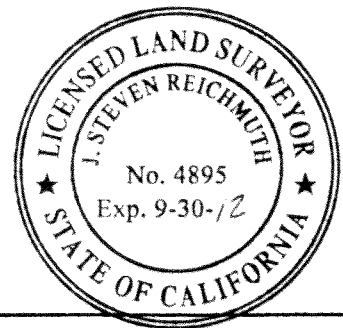

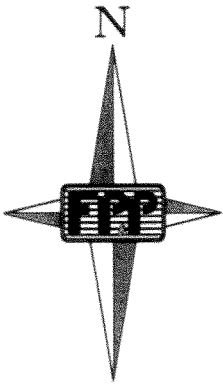

1" = 40'

